



BMW- Ø 84

87-70205-STD



**Motor Özellikleri**  
(Engine Specifications)

İmalatçı (Manufacturer):  
BMW  
Çap (Diameter): 84  
FM Grup No: 1446

**M54**  
6 Sil. Benzinli 2500cc  
125-170 KW(170-231PS)  
10.5:1  
325i, 525i, X3, X5, Z3, Z4  
2000 - 2007

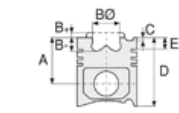

**Piston Ölçüleri**  
(Piston Dimensions)

A : 27.600  
C1 : 2.600  
D : 47.600  
E : 5.000

Pim: 22 x 56



**Piston Özellikleri**  
(Piston Features)

Gözarası Düz  
(Flat Eye Gap)





**Piston Parça No**  
(Piston Part No)

87-425300-02  
87-70205-STD  
87-425307-02  
87-70205 0,50



**Segman Seti**  
(Ring Set)

06-425300-00-STD  
06-425307-00 0.50 mm  
1.200  NT ST  
1.500  P GOE  
2.000  P KV4

Goetze® LKZ-Ring® /  
Yağ segmanı matkap  
delikli(Oil Ring Drill  
Perforated)



**Silindir Gömleği**  
(Liner)

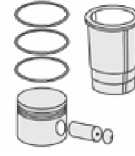

**Silindir Kit**  
(Assembly Set)

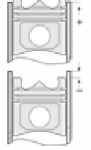

**Piston - Blok Montaj**  
**Yüksekliği**  
(Piston - Block  
Assembly Height)

