



BMW- Ø 84

87-70214-STD



**Motor Özellikleri**  
(Engine Specifications)

**Piston Ölçüleri**  
(Piston Dimensions)

**Piston Parça No**  
(Piston Part No)

**Segman Seti**  
(Ring Set)

**Silindir Gömleği**  
(Liner)

**Silindir Kit**  
(Assembly Set)

**Piston - Blok Montaj**  
**Yüksekliği**  
(Piston - Block  
Assembly Height)

İmalatçı (Manufacturer):  
BMW  
Çap (Diameter): 84  
FM Grup No: 1421

A : 31.820  
C1 : 1.550  
C2 : 1.700  
D : 51.820  
E : 8.100

87-815500-02  
87-70214-STD  
87-815507-02  
87-70214-050

06-815500-50-STD  
06-815507-50 0,50 mm  
1.500 CKP KV1  
1.500 STD  
2.000 CR ST

14-020710-00 D  
B : 87.000  
L : 137.000  
D : 88.500  
C : 6.000

**M52B 28GG**

6 Sil. Benzinli 2791cc  
141Kw (191PS) 10,2:1  
24v enjektörlü, katalizörlü  
(With Injector, With  
Catalyst)  
328i, 528i, 728i  
1995 - 1998

Pim: 22 x 56

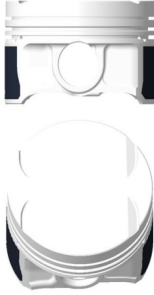

**Piston Özellikleri**  
(Piston Features)

Gözarası Düz  
(Flat Eye Gap)

