

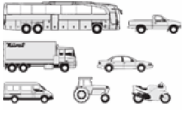

FIAT - Ø 86,4

87-70741-STD A



**Motor Özellikleri**  
(Engine Specifications)

İmalatçı (Manufacturer):  
FIAT  
Çap (Diameter): Ø 86,4  
FM Grup No: 2815

**M202PB.15.A /**  
**160 A2.000**  
4 Sil. Benzinli 1581cc  
72 Kw (96 PS)  
TIPO, TEMPRA 1.6  
SX, TIPO,  
TEMPRA 1.6 SX A,  
TIPO, TEMPRA  
1.6 SX AK  
1990...

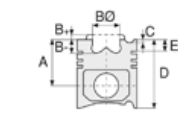

**Piston Ölçüleri**  
(Piston Dimensions)

A : 33.300  
B - : 2.300  
BØ : 71.000  
C1 : 3.200  
D : 65.300  
E : 6.500

Pim : 22 x 63,2



**Piston Özellikleri**  
(Piston Features)

Göz Arası Düz  
(Flat Eye Gap)



**Piston Parça No**  
(Piston Part No)

87-074971-12  
87-70741-100A  
87-074960-12  
87-70741-STD A  
87-074966-12  
87-70741-040A  
87-074968-12  
87-70741-060A  
87-074970-10  
87-70741-080A

87-074960-22  
87-70741-STD B  
87-074966-22  
87-70741-040B  
87-074968-22  
87-70741-060B  
87-074970-22  
87-70741-080B



**Segman Seti**  
(Ring Set)

06-074960-10-STD  
06-074966-10-0,40 mm  
06-074968-10-0,60 mm  
06-074970-10-0,80 mm  
06-074971-10-1,00 mm

1.500 CRP KV1  
1.750 P STD  
3.000 CRP STD

06-074960-50-STD  
06-074966-50-0,40 mm  
06-074968-50-0,60 mm  
1.500 CRP KV1  
1.750 P STD  
3.000 CRP ST



**Silindir Gömleği**  
(Liner)

14-020060-00-D  
B : 90.000  
L : 127.000  
D : 91.000  
C : 5.000

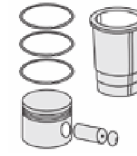
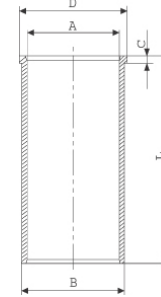

**Silindir Kit**  
(Assembly Set)

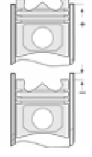

**Piston - Blok Montaj**  
**Yüksekliği**  
(Piston - Block  
Assembly Height)

