



IVECO LKW - Ø 120

87-70758-STDA



Motor Özellikleri
(Engine Specifications)

İmalatçı (Manufacturer):
IVECO LKW
Çap (Diameter): Ø 120
FM Grup No: 4063

8460.41E EURO2
6 Sil. Dizel 9498cc
276 Kw (375 PS)
Ap160, AP160.26,
AP160/12.26,
AP160.26, AP160/12.26

Piston Ölçüleri
(Piston Dimensions)

A : 84.700
B - : 27.400
BØ : 60.000
C1 : 3.180
C2 : 3.180
D : 134.700
E : 9.500

Pim: 48 x 96



Piston Özellikleri
(Piston Features)

Segman Taşıyıcı
(Ring Carrier)
Soğutma Kanallı
(Coolin Gallery)
Yağ Püskürtme Oyuğu
(Oil Jet Cut-out)
Burçlu Piston
(Bushing Piston)
Gözarası Konik
(Conical Eye Gap)

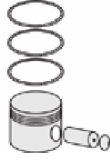

Piston Parça No
(Piston Part No)

87-854900-32
87-70758-STDA



Segman Seti
(Ring Set)

06-854900-20-STD

3.500 CR KV1
3.000 CR IKA
5.000 CR STD



Silindir Gömleği
(Liner)

14-450020-00-WH
B : 134.000
L : 249.250
D : 144.800
C : 10.100
F : 1.000

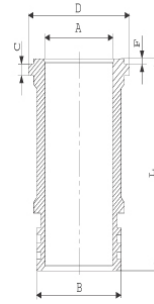

Dış Yüzeyi Fosfat Kaplı
(Outer Surface
Phosphate Coated)

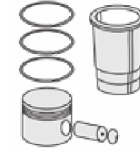

Silindir Kit
(Assembly Set)

88-854900-32-STD
88-70758-STDA

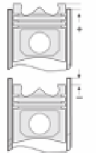

Piston - Blok Montaj
Yüksekliği
(Piston - Block
Assembly Height)

+0,36 / +0,84

