



IVECO LKW - Ø 137

87-70785-STDB



Motor Özellikleri
(Engine Specifications)

İmalatçı (Manufacturer):
IVECO LKW
Çap (Diameter): Ø 137
FM Grup No: 4023

8210.22S

6 Sil. Dizel 13798cc
243 Kw (330 PS) 15:1
Turbo Intercooled
190, 190
1984....

8210.22.000

6 Sil. Dizel 13798cc
223,5 Kw (304 PS) 15:1
Turbocharge
170, 190, 240, 260, 370
1980....

8215.22

6 Sil. Dizel 13798cc
173 Kw (235 PS) 15:1
Turbocharge
RAUPE FL20,
RAUPE FR20
1987 - 1991

Piston Ölçüleri
(Piston Dimensions)

A : 92.000
B - : 33.000
BØ : 72.000
BX : 5.000
D : 162.000
E : 23.000

Pim: 50 x 117

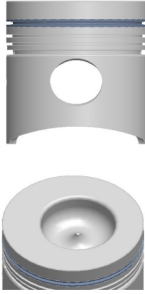

Piston Özellikleri
(Piston Features)

Segman Taşıyıcı
(Ring Carrier)
Sert Anotlama
(Hard Anodizing)
Soğutma Kanallı
(Coolin Gallery)
Gözarası Konik
(Conical Eye Gap)



Piston Parça No
(Piston Part No)

87-030460-02
87-70785-STDB

87-207800-02
87-70785-STDD



Segman Seti
(Ring Set)

06-030460-20-STD

4.000 CRP KV1
3.000 CRP IKA
3.000 P STD
5.500 CRP STD

Goetze® LKZ-Ring®

06-030460-20-STD

4.000 CR KV1
3.000 STD
3.000 STD
5.500 CR STD



Silindir Gömleği
(Liner)

14-021560-10-DH
B : 143.000
L : 282.000
D : 147.000
C : 6.000

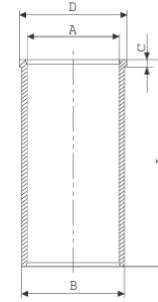

14-021561-10-DH
B : 143.050
L : 282.000
D : 147.000
C : 6.000

Dış Çap 0,05 MM
Farklı (Outside
Diameter
0,05 mm Different)

14-021562-10-DH
B : 143.250
L : 282.000
D : 147.000
C : 6.000

Dış Çap 0,25 MM
Farklı (Outside
Diameter
0,25 mm Different)

14-021563-10-DH
B : 143.500
L : 282.000
D : 147.000
C : 6.000

Dış Çap 0,50 MM
Farklı (Outside
Diameter
0,50 mm Different)

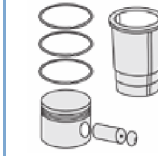

Silindir Kit
(Assembly Set)

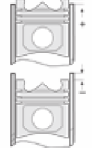

Piston - Blok Montaj
Yüksekliği
(Piston - Block
Assembly Height)

- 0,275 / + 0,225

