



IVECO LKW - Ø 137

87-70787-STD A

**Motor Özellikleri**  
*(Engine Specifications)*

İmalatçı (Manufacturer):  
IVECO LKW  
Çap (Diameter): Ø 137  
FM Grup No: 4025

**8210.42.K / TRM 40 / TRM 45**

6 Sil. Dizel 13798cc  
272 Kw (370 PS) 16,5:1

Turbocharge

Motor no: --&gt; 294803

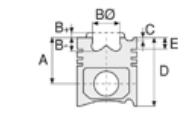
190 E 37 EUROTRAKKER,  
190 E37 EUROTRAKKER,  
260 E37 EUROTRAKKER,  
330 E37 EUROTRAKKER,  
380 E37 EUROTRAKKER,  
400 E37 EUROTRAKKER,  
440 E37 EUROTRAKKER,  
720 E37 EUROTRAKKER  
1990....

**Piston Ölçüleri**  
*(Piston Dimensions)*

A : 92.000  
B- : 21.000  
BØ : 83.800  
BX : 3.000  
D : 157.000  
E : 8.000

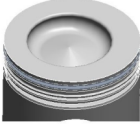
Pim: 50 x 115

**Piston Özellikleri**  
*(Piston Features)*

Segman Taşıyıcı  
(Ring Carrier)  
Sert Anotlama  
(Hard Anodizing)  
Soğutma Kanallı  
(Coolin Gallery)  
Yağ Püskürtme Oyuğu  
(Oil Jet Cut-out)  
Gözarası Konik  
(Conical Eye Gap)

**Piston Parça No**  
*(Piston Part No)*

87-783000-33  
87-70787-STD1A  
- 0,20 mm kısa  
87-783000-32  
87-70787-STD A

87-836500-22  
87-70787-STD B

87-783000-14  
87-70787-STD D

**Segman Seti**  
*(Ring Set)*

06-783000-20-STD

4.000 CR KV1  
3.000 CR IKA  
5.500 CR STD

Goetze® LKZ-Ring®

06-836500-20-STD

4.000 CR KV1  
3.000 CR IKA  
5.500 CR STD

Goetze® LKZ-Ring®

06-783000-40-STD

4.000 CR KV1  
3.000 CR F14  
5.500 CR GOE

**Silindir Gömleği**  
*(Liner)*

14-020230-10-DH

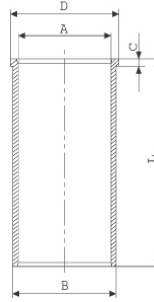
B : 143.000  
L : 282.000  
D : 149.000  
C : 6.000

Dış Yüzeyi Fosfat  
Kaplı (Outer Surface  
Phosphated Covered)

14-020231-10-DH

B : 143.050  
L : 282.000  
D : 149.000  
C : 6.000

Dış Çap 0,05 mm  
Farklı (Outer Diameter  
0,05 mm Different)

14-020232-10-DH

B : 143.250  
L : 282.000  
D : 149.000  
C : 6.000

Dış Çap 0,25 mm  
Farklı (Outer Diameter  
0,25 mm Different)

14-020233-10-DH

B : 143.500  
L : 282.000  
D : 149.000  
C : 6.000

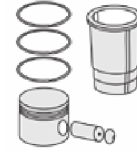
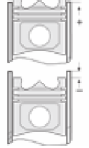
Dış Çap 0,50 mm  
Farklı - Fosfat Kaplı  
(Outer Diameter 0,50  
mm Different -  
Phosphated Coated)

**Silindir Kit**  
*(Assembly Set)*

**Piston - Blok Montaj**  
*(Piston - Block Assembly Height)*

- 0,27 / + 0,22

**FEDERAL-MOGUL**  
**POWERTRAIN**  
TÜRKİYE