



Motor Özellikleri
(Engine Specifications)

İmalatçı (Manufacturer):
FORD PKW
Çap (Diameter): 80,96
FM Grup No: 2913

2735E, 6110E
4 Sil. Benzinli 1298cc
35,5 Kw (48 PS) 8:1

ANADOL 1300,
CAPRI II 1300L,
ESCORT 1300L, GL, XL, S
1968 - 1980

Piston Ölçüleri
(Piston Dimensions)

A : 44.120
B- : 16.050
BØ : 53.800
BX : 3.550
C1 : 2.840
D : 83.820
E : 9.680

Pim: 20,62 x 71,3

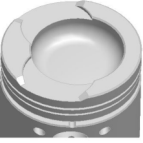

Piston Özellikleri
(Piston Features)

Segman Taşıyıcı
(Ring Carrier)
Çelik Plaka
(Steel Strut)
Yağ Püskürtme Oyuğu
(Oil Jet Cut-out)
Göz arası düz
(Flat Eye Gap)

Piston Parça No
(Piston Part No)

87-838800-02
87-70825-STD
87-838807-02
87-70825 020
87-838809-02
87-70825 030
87-838811-02
87-70825 040
87-838814-02
87-70825 060

Segman Seti
(Ring Set)

06-838800-00-STD
06-838807-00 0,020"
06-838809-00 0,030"
06-838811-00 0,040"
06-838814-00 0,060"
1.587 CRP KV1
1.980 P STD
3.947 CRP STD

Silindir Gömleği
(Liner)

14-025930-00-D
B : 85.000
L : 124.000
D : 86.000
C : 6.000

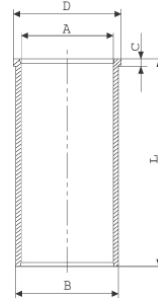

14-025931-00-D
B : 85.500
L : 124.000
D : 86.500
C : 6.000

Dış Çap 0,50mm Farklı
(Outer Diameter
0,50mm Different)

14-025932-00-D
B : 86.000
L : 124.000
D : 87.000
C : 6.000

Dış Çap 1,00mm Farklı
(Outer Diameter
1,00mm Different)

Silindir Kit
(Assembly Set)

Piston - Blok Montaj
Yüksekliği
(Piston - Block
Assembly Height)

