



FORD LKW - Ø 104,77

87-70888-STD



**Motor Özellikleri**  
(Engine Specifications)

İmalatçı (Manufacturer):  
FORD LKW  
Çap (Diameter): Ø 104,77  
FM Grup No: 3069

**DOVER 6.0 TCI**  
**EURO1**

6 Sil. Dizel 5946cc  
Turbo Intercooled  
CARGO 2116,  
CARGO 2520L  
2002....

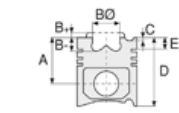

**Piston Ölçüleri**  
(Piston Dimensions)

A : 71.230  
B- : 20.800  
BØ: 51.900  
BX : 4.800  
D : 112.880  
E : 18.300

Pim: 41 x 87,12

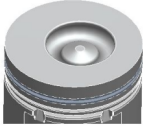
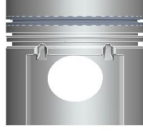

**Piston Özellikleri**  
(Piston Features)

Segman Taşıyıcı  
(Ring Carrier)  
Gözarası Konik  
(Conical Eye Gap)

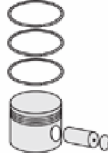

**Piston Parça No**  
(Piston Part No)

87-843400-22  
87-70888-STD



**Segman Seti**  
(Ring Set)

06-843400-00-STD

3.000 PSP KVI  
2.500 P STD  
4.000 NT ST



**Silindir Gömleği**  
(Liner)

14-040060-00-D  
B : 109.075  
L : 218.510  
D : 113.000  
C : 5.000

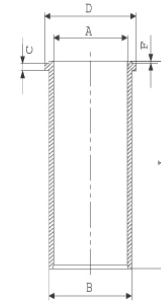

14-040060-00-DH

14-040061-00 D  
B : 109.575  
L : 218.510  
D : 113.000  
C : 5.000  
F : 0.700

Dış Çap 0,50mm Farklı  
(Outside Diameter  
0,50 mm Different)

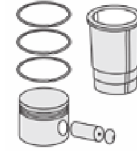

**Silindir Kit**  
(Assembly Set)

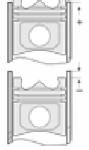

**Piston - Blok Montaj**  
**Yüksekliği**  
(Piston - Block  
Assembly Height)

+0,25/+0,40

