



HYUNDAI - Ø 75,5

87-71132-STD



Motor Özellikleri
(Engine Specifications)

İmalatçı (Manufacturer):
HYUNDAI
Çap (Diameter): Ø 75,5
FM Grup No: 3602

G15B

4 Sil. Benzinli 1468cc 56
Kw (76 PS) 8, 5:1
EXCEL 1.5
1990 - 1994

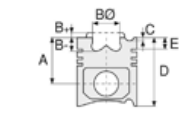

Piston Ölçüleri
(Piston Dimensions)

A : 29.400
B- : 3.700
D : 58.800
E : 6.900

Pim : 18 x 60



Piston Özellikleri
(Piston Features)

Biyel Koluna Sıkı Geçme
(Close-Fit to Connecting Rod)
Gözarası Düz
(Flat Eye Gap)

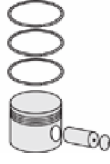

Piston Parça No
(Piston Part No)

87-286700-02
87-71132-STD
87-286707-02
87-71132-050



Segman Seti
(Ring Set)

06-286700-00-STD
06-286707-00-0,50 mm
1.500 CRP IKA
1.500 P STD
4.000 P STD



Silindir Gömleği
(Liner)

14-021800-00-D
B : 78.500
L : 132.000
D : 79.500
C : 5.000

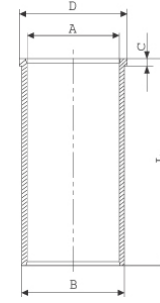

14-021801-00-D
B : 79.000
L : 132.000
D : 80.000
C : 5.500

Dış Çap 0,50 mm farklı
(Outside Diameter
0,50 mm different)

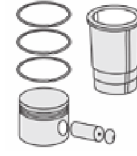

Silindir Kit
(Assembly Set)

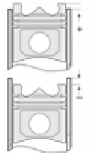

Piston - Blok Montaj
Yüksekliği
(Piston - Block
Assembly Height)

