



ISUZU - Ø 95,4

87-71220-STD



**Motor Özellikleri**  
(Engine Specifications)

İmalatçı (Manufacturer):  
ISUZU  
Çap (Diameter): Ø 95,4  
FM Grup No: 3922

**4JK1-TC EURO 4**  
4 Sil. Dizel 2499cc  
85-100 KW / 116-136  
PS 18,0:1  
D-MAX  
2005...

**Piston Ölçüleri**  
(Piston Dimensions)

A : 58.500  
B- : 16.750  
BØ : 45.800  
D : 87.250  
E : 10.700

Pim: 34 x 78



**Piston Özellikleri**  
(Piston Features)

Segman Taşıyıcı  
(Ring Carrier)  
Soğutma Kanallı  
(Coolin Gallery)  
Yağ Püskürtme Oyuğu  
(Oil Jet Cut-out)  
Gözarası Konik  
(Conical Eye Gap)

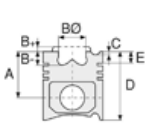

**Piston Parça No**  
(Piston Part No)

87-853900-02  
87-71220-STD  
87-853907-02  
87-71220 0,50

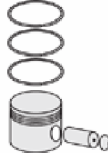

**Segman Seti**  
(Ring Set)

06-853900-00-STD  
06-853907-00 0,50 mm  
2.000 PVD ST  
1.500 CR GOE  
3.000 NT ST



**Silindir Gömleği**  
(Liner)



**Silindir Kit**  
(Assembly Set)

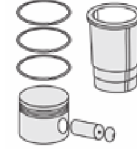

**Piston - Blok Montaj**  
**Yüksekliği**  
(Piston - Block  
Assembly Height)

0,95 mm Conta ile  
(With Gasket)  
0,067-0,117  
1,00 mm Conta ile  
(With Gasket)  
0,117-0,167  
1,05 mm Conta ile  
(With Gasket)  
0,167-0,217

