



ISUZU - Ø 93,03

87-71226-STD



Motor Özellikleri
(Engine Specifications)

İmalatçı (Manufacturer):
ISUZU
Çap (Diameter): Ø 93,03
FM Grup No: 3919

4JB1-T
4 Sil. 2771cc 71 KW (97 PS)
BIGHORN, TROOPER
1987 - 1991

Piston Ölçüleri
(Piston Dimensions)

A : 51.850
B- : 19.500
BØ : 43.900
BX : 4.000
BY : 1.000
C1 : 0.550
D : 91.850
E : 14.000

Pim : 34 x 78

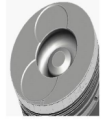

Piston Özellikleri
(Piston Features)

Segman Taşıyıcı
(Ring Carrier)
Çelik Plaka
(Steel Strut)
Yağ Püskürtme Oyuğu
(Oil Jet Cut-Out)
Gözarası Konik
(Conical Eye Gap)



Piston Parça No
(Piston Part No)

87-246200-62
87-71226-STD



Segman Seti
(Ring Set)

06-246200-00-STD
2.000 P GOE
2.000 P STD
4.000 P GOE



Silindir Gömleği
(Liner)

14-021460-10-DH
B : 95.040
L : 181.000
D : 101.000
C : 0.820

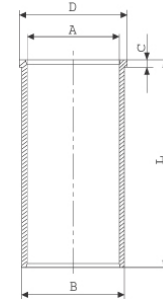

İçi Krom Kaplı, Çelik Gömlek
(Chrome Plated, Steel Shirt)

14-021461-10-DH
B : 95.250
L : 181.000
D : 101.000
C : 0.820

Dış çap 0,25 mm farklı
(Outer diameter
0.25 mm different)

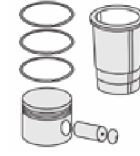

Silindir Kit
(Assembly Set)

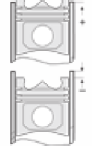

Piston - Blok Montaj
Yüksekliği
(Piston - Block
Assembly Height)

1,60 mm Conta İle
(With Gasket) 0,70 / 0,77

1,65 mm Conta İle
(With Gasket) 0,78 / 0,80

1,70 mm Conta İle
(With Gasket) 0,81 / 0,88

