



IVECO LKW - Ø 110

87-71702-STD A



**Motor Özellikleri**  
(Engine Specifications)

İmalatçı (Manufacturer):  
IVECO LKW  
Çap (Diameter): Ø 110  
FM Grup No: 4014

**CO3/20/21/41**

4 Sil. Dizel 4562cc 17:1  
130 NC, 329 A,  
50 A1, 65 NC, 70 NC,  
75 NC, 850, 850 C,  
850 S, CERBIATTO 20,  
DAINO 40, DAINO 45,  
LEONCINO 35,36  
1969 - 1978

**CO3/70/100**

4 Sil. Dizel 4941cc 17:1  
CERBIATTO,  
LEONCINO A 15,  
TIGROTTO 50,55,  
65,75,M5K  
1969 - 1978

**CP3**

6 Sil. Dizel 7412cc 17,4:1  
130 NC, 130 NR,  
130 NT, 673 N,  
673 NR, 673 T  
1969....

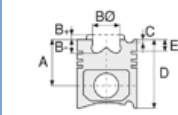

**Piston Ölçüleri**  
(Piston Dimensions)

A : 75.200  
B- : 27.600  
BØ : 51.000  
D : 150.200  
E : 15.500

Pim: 40 x 94



**Piston Özellikleri**  
(Piston Features)

Gözarası Konik  
(Conical Eye Gap)

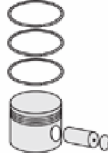

**Piston Parça No**  
(Piston Part No)

87-207500-12  
87-71702-STD A



**Segman Seti**  
(Ring Set)

06-207500-20-STD

2.500 CRP STD  
2.500 STD  
2.500 STD  
5.000 CRP STD



**Silindir Gömleği**  
(Liner)

14-611250-00-WH  
B : 118.000  
L : 237.000  
D : 129.500  
C : 170.000  
F : 1.000

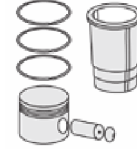
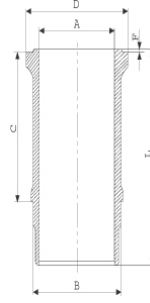

**Silindir Kit**  
(Assembly Set)

88-207500-12-STD  
88-71702-STD A

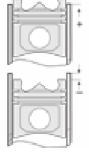

**Piston - Blok Montaj**  
Yüksekliği  
(Piston - Block  
Assembly Height)

