



IVECO LKW - Ø 102

87-72854-STD



Motor Özellikleri
(Engine Specifications)

İmalatçı (Manufacturer):
IVECO LKW
Çap (Diameter): Ø 102
FM Grup No: 4064

F4AE 0681 EURO 3

TECTOR C.RAİL

6 Sil. Dizel 5880cc
210/240 Ps

100 E 18 Eurocargo,
150 E 21 Eurocargo,
160 E 24 Eurocargo,
180 E 28 Eurocargo,
220 E 21 Eurocargo,
250 E 24 Eurocargo
2005....

F4AE 0481 EURO 3

TECTOR C.RAİL

4 Sil.mDizel 3920cc

150/130 PS
CUMMINS İLE ORTAK
MOTOR

(Common Engine With
Cummins)

130 E 15 Eurocargo,
85 E 13 Eurocargo,
Eurobus 31.17,
Eurobus 35.17
2005....

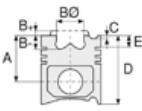

Piston Ölçüleri
(Piston Dimensions)

A : 71.400
B- : 18.500
BØ : 56.500
D : 105.300
E : 8.000

Pim: 40 x 82,7



Piston Özellikleri
(Piston Features)

Segman Taşıyıcı
(Ring Carrier)
Soğutma Kanallı
(Coolin Gallery)
Yağ Püskürtme Oyuğu
(Oil Jet Cut-out)
Gözarası Konik
(Conical Eye Gap)



Piston Parça No
(Piston Part No)

87-135200-02
87-72854-STD

87-135207-02
87-72854 0,50

87-135200-03
87-72854-STD1
0,20 mm Kısa (Short)



Segman Seti
(Ring Set)

06-135200-00-STD
06-135207-00 0,50 mm

3.000 CKP KVI
2.390 P GOE
4.000 CR GOE



Silindir Gömleği
(Liner)

14-014530-00-D
B : 104.565
L : 200.000

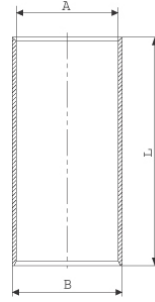

14-014531-00-D
B : 105.065
L : 200.000

Dış Çap 0,50mm Farklı
(Outside Diameter
0,50 mm Different)

14-014532-00-D
B : 105.565
L : 200.000

Dış Çap 1,00mm Farklı
(Outside Diameter
1,00 mm Different)

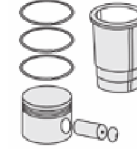

Silindir Kit
(Assembly Set)

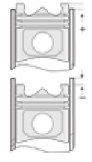

Piston - Blok Montaj
Yüksekliği
(Piston - Block
Assembly Height)

+0,28 /+0,52

