

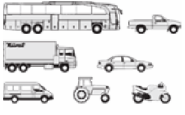

IVECO LKW - Ø 135

87-72883-STD



Motor Özellikleri
(Engine Specifications)

İmalatçı (Manufacturer):
IVECO LKW
Çap (Diameter): Ø 135
FM Grup No: 4067

**F3B0681 Cb401/
402/411 Cursor13**
Euro3

6 Sil. Dizel 12882cc
279/324/338/353/397
Kw(380/440/460/
480/540)

Turbo, Intercooler

Eurotrakker MP 260E38H,
Eurotrakker MP 260E38W,
Eurotrakker MP 340E38H,
Eurotrakker MP 340E38HB,
Eurotrakker MP 380E38H,
Eurotrakker MP 380E38W,
Eurotrakker MP 410E38H,
Eurotrakker MP190,
Eurotrakker MP190E38W,
Eurotrakker MPU 410E38H,
Trakker AD 190T38,
Trakker AD 190T38W,
Trakker AD 260T38,
Trakker AT 190T38,
Trakker AT 190T38W,
Trakker AT 260T38
2000....

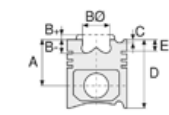

Piston Ölçüleri
(Piston Dimensions)

A : 90.400
B- : 23.100
BØ : 94.000
D : 142.400
E : 8.900

Pim: 54 x 107,5



Piston Özellikleri
(Piston Features)

Segman Taşıyıcı
(Ring Carrier)
Soğutma Kanallı
(Coolin Gallery)
Yağ Püskürtme Oyuğu
(Oil Jet Cut-out)
Gözarası Konik
(Conical Eye Gap)

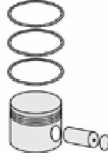

Piston Parça No
(Piston Part No)

87-122000-02
87-72883-STD



Segman Seti
(Ring Set)

06-122000-20-STD

4.000 CK KV1
3.000 CR F14
5.000 CR GOE

Goetze® LKZ-Ring®



Silindir Gömleği
(Liner)

14-260050-00-WH

B : 151.000
L : 254.000
D : 161.600
C : 9.960
F : 1.200

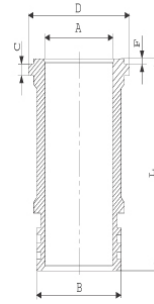

Dış Yüzeyi Fosfat
Kaplı / O-RING Bilgi
(Outer Surface
Phosphate Coated /
O RING Information)
24-35043-80/O
3x 145,60*3,53 FPM

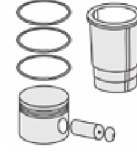

Silindir Kit
(Assembly Set)

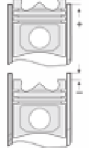

Piston - Blok Montaj
Yüksekliği
(Piston - Block
Assembly Height)

000/0,50

