



Motor Özellikleri
(Engine Specifications)

İmalatçı (Manufacturer):
CATERPILLAR
Çap (Diameter): Ø 137,16
FM Grup No: 1709

3406

6 Sil. Dizel
980F, D8N
1979 - 1993

3408

8 Sil. Dizel
980F, D8L, D9L
1979 - 1993

3412

12 Sil. Dizel
988B, D9L
1979 - 1993

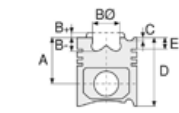

Piston Ölçüleri
(Piston Dimensions)

A : 88.050
B- : 16.200
BØ : 94.000
D : 137.250
E : 21.600

Pim: 50,8 x 111,9



Piston Özellikleri
(Piston Features)

Çift Segman Taşıyıcı
(Double Ring Carrier)
Yağ Püskürtme Oyuğu
(Oil Jet Cut-out)
Göz Arası Konik
(Conical Eye Gap)

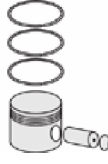

Piston Parça No
(Piston Part No)

87-824600-02
87-70335-STD



Segman Seti
(Ring Set)

06-824600-00-STD
3.960 CRP KV4
3.110 CRP KV1
3.115 CRP KV1



Silindir Gömleği
(Liner)

14-480030-00-WH
B : 153.750
L : 274.500
D : 165.200
C : 8.880
F : 1.000

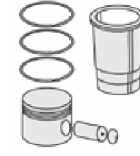
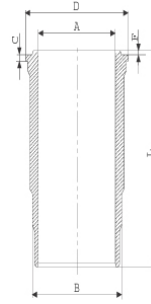

Silindir Kit
(Assembly Set)

88-824600-02-STD
88-70335-STD

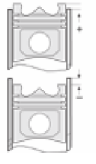

Piston - Blok Montaj
Yüksekliği
(Piston - Block
Assembly Height)

14-480630-00-WH
B : 153.797
L : 273.300
D : 165.252
C : 8.915
F : 1.117

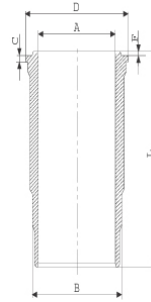

İndüksiyonlu
(Induction)

