



CITROEN - Ø 83

87-70383-STDA



Motor Özellikleri
(Engine Specifications)

İmalatçı (Manufacturer):
CITROEN
Çap (Diameter): Ø 83
FM Grup No: 1902

XU9JA/J1/J2/JAZ/M
4 Sil. Benzinli 1905cc 9,3:1
8v MPi
19 Evasion XU9J1(D6A)
XUPJ2(DFZ), 19 RI XU9J1
(D6A)XUPJ2(DFZ),
19 RI XU9JA(DDZ-DKZ),
19 TRI XU9JA(DDZ-DKZ),
19GTI XU9J1(D6A)XUPJ2
(DFZ), 19GTI XU9JA
(DDZ-DKZ), 19TRI XU9J1
(D6A)XUPJ2(DFZ), BX 19
4WD XU9JA(DDZ-DKZ),
BX 19 4x4 XU9J1(D6A)
XUPJ2(DFZ), ZX Volcane
XU9 JA(D6E) XU9 JAZ
1986 - 1998

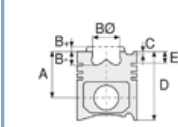

Piston Ölçüleri
(Piston Dimensions)

A : 37.500
B- : 8.900
D : 67.500
E : 8.500

Pim: 22 x 66,2

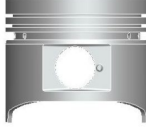

Piston Özellikleri
(Piston Features)

Çelik Plaka
(Steel Strut)
Biyel Koluna Sıkı Geçme
(Close-fit to
Connecting Rod)
Gözarası Düz
(Flat Eye Gap)

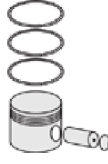

Piston Parça No
(Piston Part No)

87-322400-12
87-70383-STDA



Segman Seti
(Ring Set)

06-322400-90-STD

1.500 CKP IKA
1.500 P STD
4.000 CRP STD



Silindir Gömleği
(Liner)

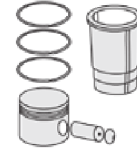

Silindir Kit
(Assembly Set)

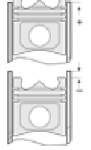

Piston - Blok Montaj
Yüksekliği
(Piston - Block
Assembly Height)

