



Motor Özellikleri
(Engine Specifications)

İmalatçı (Manufacturer):
MERCEDES BENZ PKW
Çap (Diameter): Ø 87
FM Grup No: 5813

OM 601

4 Sil. Dizel 1997cc 53
Kw (72 PS) 22:1
190 D, 200 D
1984 - 1991

OM 602

5 Sil. Dizel 2497cc 66
Kw (90 PS) 22:1
190 D 2.5, 250 D
1984 - 1991

OM 603

6 Sil. Dizel 2996cc 80
Kw (109 PS) 22:1 300 D
1984 - 1994

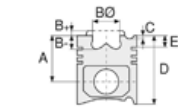

Piston Ölçüleri
(Piston Dimensions)

A : 44.850
B - : 9.050
C1 : 1.050
C2 : 1.250
D : 74.850
E : 12.800

Pim : 26 x 55

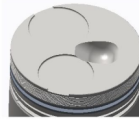

Piston Özellikleri
(Piston Features)

Segman Taşıyıcı
(Ring Carrier)
Çelik Plaka
(Steel Strut)
Yağ Püskürtme Oyuğu
(Oil Jet Cut-Out)
Gözarası Düz
(Flat Eye Gap)

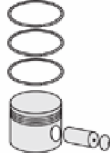

Piston Parça No
(Piston Part No)

87-743600-02
87-70467-STD A

87-743607-02
87-70467-050A

87-743611-02
87-70467-1,00A

87-183300-12
87-70467-STD B

87-183307-12
87-70467-050B



Segman Seti
(Ring Set)

06-743600-00-STD
06-743607-00-0,50 mm
06-743611-00-1,00 mm

2.500 CRP KV1
2.000 P F14
3.000 CRP STD

06-183300-90-STD
06-183307-90-0,50 mm

2.500 CKP KV1
2.000 CKP KV1
3.000 CRP STD



Silindir Gömleği
(Liner)

14-022180-00-D
B : 90.000
L : 148.600
D : 92.550
C : 4.700

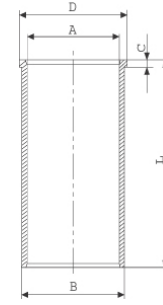

14-022181-00-D
B : 90.500
L : 148.600
D : 93.050
C : 5200.000

Dış Çap 0,50 mm Farklı
(Outside Diameter
0.50mm Different)

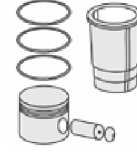

Silindir Kit
(Assembly Set)

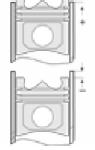

Piston - Blok Montaj
Yüksekliği
(Piston - Block
Assembly Height)

+ 0,735 / + 0,965

