



Motor Özellikleri
(Engine Specifications)

İmalatçı (Manufacturer):
MERCEDES BENZ PKW
Çap (Diameter): Ø 87
FM Grup No: 5819

**OM 615.910-912,914,
916,917**

4 Sil. Dizel 2197cc 44-49
Kw (60-67PS) 21:1 206 D,
220 D, 306, 406, 408, 409,
O 309, U 45, U 52
1968 - 1978

OM 615.941

4 Sil. Dizel 2197cc 44
Kw (60 PS) 21:1 206 D,
220 D, 306, 406, 408,
409, O 309, U 45, U 52
1972 - 1978

**OM 615.918,919,930,
936-939**

4 Sil. Dizel 2197cc 37Kw
(50 PS) 21:1 206 D, 220 D,
306, 406, 408, 409,
O 309, U 45, U 52
1968 - 1972

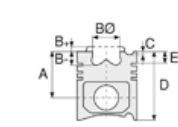

Piston Ölçüleri
(Piston Dimensions)

A : 48.250
B - : 6.350
BØ : 57.000
BX : 5.000
C1 : 1.100
D : 89.650
E : 15.250

Pim : 26 x 72



Piston Özellikleri
(Piston Features)

Segman Taşıyıcı
(Ring Carrier)
Çelik Plaka
(Steel Strut)
Gözarası Düz
(Flat Eye Gap)



Piston Parça No
(Piston Part No)

87-170600-12
87-70477-STD A

87-170607-12
87-70477-050A

87-170611-12
87-70477-100A



Segman Seti
(Ring Set)

06-170600-90-STD
06-170607-90-0,50 mm
06-170611-90-1,00 mm

1.600 CKP KV1
1.500 P STD
2.500 CR ST



Silindir Gömleği
(Liner)

14-022190-00-D
B : 90.000
L : 158.400
D : 92.000
C : 4.700

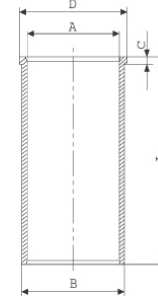

14-022191-00-D
B : 90.500
L : 158.400
D : 92.500
C : 4.700

Dış Çap 0,50mm Farklı
(Outside Diameter
0.50mm Different)

14-022192-00-D
B : 91.000
L : 158.400
D : 93.000
C : 4.700

Dış Çap 1,00mm Farklı
(Outside Diameter
1.00mm Different)

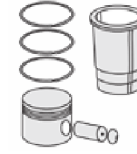

Silindir Kit
(Assembly Set)

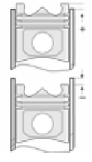

Piston - Blok Montaj
Yüksekliği
(Piston - Block
Assembly Height)

+ 0,40 / + 0,70

