



MERCEDES BENZ PKW - Ø 89

87-70488-STD



Motor Özellikleri
(Engine Specifications)

İmalatçı (Manufacturer):
MERCEDES BENZ PKW
Çap (Diameter): Ø 89
FM Grup No: 5829

OM 601D 23A.970

4 Sil. Dizel 2299cc 72
Kw (98 PS) 22:1
Turbo Istana 2.3D,
Korando 2.3D, Musso 2.3D,
VITO 108D, VITO 110D
1996 - 1999

OM 603D 35A.970-972

6 Sil. Dizel 3449cc 100
Kw (136 PS) 22:1 Turbo
350GD, 350S
1992 - 1997

OM 601D 23A.970

4 Sil. Dizel 2299cc 72
Kw (98 PS) 22:1 Turbo
Istana 2.3D, Korando 2.3D,
Musso 2.3D, VITO 108D,
VITO 110D
1996 - 1999

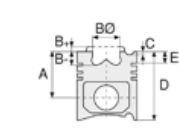

Piston Ölçüleri
(Piston Dimensions)

A : 44.650
B - : 9.060
C1 : 1.050
C2 : 1.250
D : 74.650
E : 13.000

Pim : 28 x 70

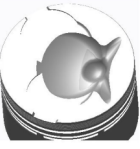

Piston Özellikleri
(Piston Features)

Segman Taşıyıcı
(Ring Carrier)
Sert Anotlama
(Hard Anodizing)
Soğutma Kanallı
(Cooling Gallery)
Gözarası Düz
(Flat Eye Gap)

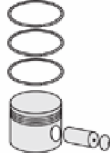

Piston Parça No
(Piston Part No)

87-743100-42
87-70488-STD

87-743107-42
87-70488-050

87-743111-42
87-70488-100

87-743100-43
87-70488-STD1
0,20 mm Kısa (Short)



Segman Seti
(Ring Set)

06-743100-00-STD
06-743107-00-0,50 mm
06-743111-00-1,00 mm

2.500 CRP KV1
2.000 P STD
3.000 CRP GOE



Silindir Gömleği
(Liner)

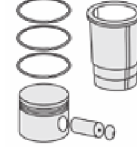

Silindir Kit
(Assembly Set)

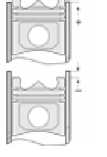

Piston - Blok Montaj
Yüksekliği
(Piston - Block
Assembly Height)

1,74 mm Conta İle
(With Gasket)
+0,83 / +1,06

1,97 mm Conta İle
(With Gasket)
+1,03 / +1,26

