



KOMATSU - Ø 105

87-71354-STD



Motor Özellikleri
(Engine Specifications)

İmalatçı (Manufacturer):
KOMATSU
Çap (Diameter): Ø 105
FM Grup No: 4704

GA-655-A
4 Sil. Dizel
Endüstriyel (Industrial)

Piston Ölçüleri
(Piston Dimensions)

A : 69.200
B : 23.700
BØ : 59.000
BX : 6.000
BY : 1.000
C1 : 1.700
C2 : 2.600
D : 107.700
E : 16.500

Pim: 40 x 85,4

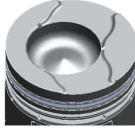

Piston Özellikleri
(Piston Features)

Segman Taşıyıcı
(Ring Carrier)
Gözarası Konik
(Conical Eye Gap)

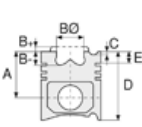

Piston Parça No
(Piston Part No)

87-861300-02
87-71354-STD
87-861300-04
87-71354-STD2
0,40 mm Kısa (Short)

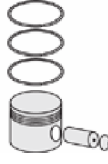

Segman Seti
(Ring Set)

06-861300-10-STD
3.000 CRP KV1
2.500 CRP STD
5.000 CRP STD
Goetze® LKZ-Ring®



Silindir Gömleği
(Liner)

14-693800-00-WH
B : 118.680
L : 223.000
D : 127.100
C : 10.100
F : 0.900

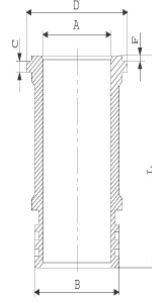

Silindir Kit
(Assembly Set)

88-861300-02-STD
88-71354-STD

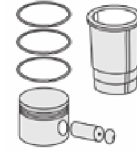

Piston - Blok Montaj
Yüksekliği
(Piston - Block
Assembly Height)

+ 0,55 / + 0,70

