



KOMATSU - Ø 130

87-71355-STD



**Motor Özellikleri**  
(Engine Specifications)

İmalatçı (Manufacturer):  
KOMATSU  
Çap (Diameter): Ø 130  
FM Grup No: 4706

4D 130  
4 Sil. Dizel  
D 57 S-1

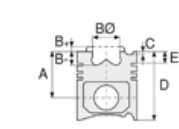

**Piston Ölçüleri**  
(Piston Dimensions)

A : 90.100  
B- : 5.500  
C1 : 3.000  
D : 135.100  
E : 22.000

Pim: 44 x 101

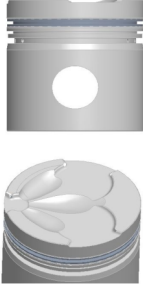

**Piston Özellikleri**  
(Piston Features)

Segman Taşıyıcı  
(Ring Carrier)  
Gözarası Konik  
(Conical Eye Gap)

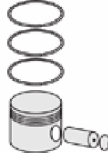

**Piston Parça No**  
(Piston Part No)

87-860800-02  
87-71355-STD



**Segman Seti**  
(Ring Set)

06-860800-10-STD

3.500  CRP KVI  
2.500  CRP STD  
5.500  CRP STD



**Silindir Gömleği**  
(Liner)

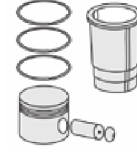

**Silindir Kit**  
(Assembly Set)

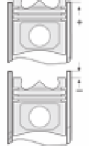

**Piston - Blok Montaj**  
Yüksekliği  
(Piston - Block  
Assembly Height)

0 / + 0,20

