



Motor Özellikleri
(Engine Specifications)

İmalatçı (Manufacturer):
KHD-FORD LKW
Çap (Diameter): Ø 108
FM Grup No: 3071

DEUTZ BF6M 1013
EURO2

6 Sil. Dizel 7146cc 195
Kw (265 PS) 17, 6:1
Turbo Intercooled /
KHD ile Ortak Motor
(With KHD Common
Engine)
1827, 2527, 3227
1999 - 2003

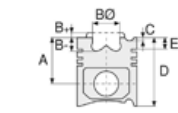

Piston Ölçüleri
(Piston Dimensions)

A : 71.150
B- : 18.800
BØ : 63.000
BX : 4.000
BY : 2.300
D : 108.000
E : 8.200

Pim : 42 x 86

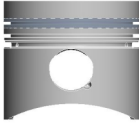

Piston Özellikleri
(Piston Features)

Segman Taşıyıcı
(Ring Carrier)
Gözarası Konik
(Conical Eye Gap)

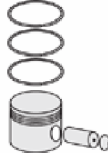

Piston Parça No
(Piston Part No)

87-136900-22
87-71487-STD



Segman Seti
(Ring Set)

06-136900-00-STD
3.000 CK KV1
2.000 NTP KV1
3.500 CRP STD
Goetze® LKZ-Ring®



Silindir Gömleği
(Liner)

14-480040-00-WH
B : 118.000
L : 229.100
D : 128.500
C : 9.000
F : 1.100

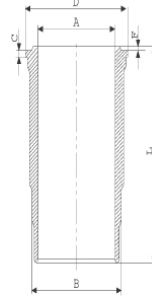

O RİNG BİLGİ
(O Ring Information)
24-35047-30/O
2 X (112*3)
FKM PEROXIDE

14-480041-00-WH
B : 118.000
L : 229.100
D : 128.500
C : 9.500
F : 1.100

Flanş Kalınlığı Ve
Flanş Alt Boğaz Çapı
+0,50 mm Farklı
(Flange Thickness And
Flange Bottom
Throat Diameter
+0.50mm Different)

14-480042-00 WH
B : 118.000
L : 229.100
D : 128.500
C : 10.000
F : 1.100

Flanş Kalınlığı Ve Flanş
Alt Boğaz Çapı +1,00
Farklı Çalışması
(Flange Thickness And
Flange Lower Throat
Diameter +1.00
Different Operation)

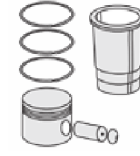

Silindir Kit
(Assembly Set)

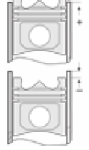

Piston - Blok Montaj
Yüksekliği
(Piston - Block
Assembly Height)

+ 0,25 / + 0,54
+ 0,54 / + 0,64
+ 0,64 / + 0,74

