



KHD - Ø 125

87-71511-STD



Motor Özellikleri
(Engine Specifications)

İmalatçı (Manufacturer):
KHD
Çap (Diameter): Ø 125
FM Grup No: 4586

BF10 L 413 F, BF10 L 513 C
10 Sil. Dizel 15945cc
265-294 KW (360-400 PS)
16.5:1 190, 320, 360
1975 - 1983

BF12 L 413 F, BF12 L 513 C
12 Sil. Dizel 19140cc
335-353 KW (456-480 PS)
16.5:1 3000, 3500, 360 D
34 AS, FKL, FKM, MFS 42,
N 4520, N 4530, N 4540,
N 4550, N 4620
1985...

BF8 L 413 F, BF8 L 513 C
8 Sil. Dizel 12763cc
212-235 KW (288-320 PS)
16.5:1 190, 2000, 250,
260, 290, 320, 360,
4520, 4530, 4550, 4620,
8000
1975...

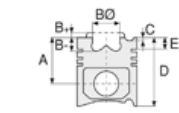

Piston Ölçüleri
(Piston Dimensions)

A : 87.400
B - : 22.400
B : 5.250
BØ : 66.000
BX : 4.000
BY : 2.000
D : 138.650
E : 23.000

Pim : 45 x 107



Piston Özellikleri
(Piston Features)

Segman Taşıyıcı
(Ring Carrier)
Sert Anotlama
(Hard Anodizing)
Soğutma Kanallı
(Cooling Gallery)
Yağ Püskürtme Oyuğu
(Oil Jet Cut-Out)
Gözarası Konik
(Conical Eye Gap)



Piston Parça No
(Piston Part No)

87-740300-72
87-71511-STD

87-740307-72
87-71511-0,50

87-740311-72
87-71511-1,00



Segman Seti
(Ring Set)

06-740300-80-STD
06-740307-80-0,50 mm
06-740311-80-1,00 mm

3.000 CK KV1
2.500 STD
4.000 CR STD
Goetze® LKZ-Ring®



Silindir Gömleği
(Liner)

14-900030-00-WH
B : 139.000
L : 250.800
D : 154.000
C : 169.500

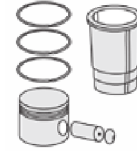
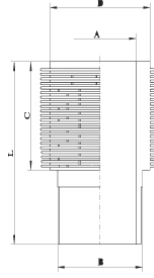

Silindir Kit
(Assembly Set)

88-740300-72-STD
88-71511-STD

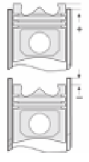

Piston - Blok Montaj
Yüksekliği
(Piston - Block
Assembly Height)

+1,15 / + 1,30

