



MITSUBISHI - Ø 80

87-71587-STD



**Motor Özellikleri**  
(Engine Specifications)

İmalatçı (Manufacturer):  
MITSUBISHI  
Çap (Diameter): Ø 80  
FM Grup No: 6001

8DC SERİSİ KOMPRESOR  
(8DC SERIES  
COMPRESSORS)  
2 Sil. Dizel  
Su Soğutmalı  
(Water Cooled)  
HAVA KOMPRESORU  
(Air Compressor)

**Piston Ölçüleri**  
(Piston Dimensions)

A : 34.500  
D : 65.000  
E : 4.000  
Pim : 16 x 72



**Piston Özellikleri**  
(Piston Features)

Gözarası Düz  
(Flat Eye Gap)

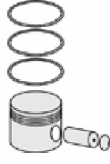

**Piston Parça No**  
(Piston Part No)

87-874300-02  
87-71587-STD



**Segman Seti**  
(Ring Set)

06-874300-50-STD  
3.000 P STD  
3.000 P STD  
3.000 P STD  
4.000 CRP ST



**Silindir Gömleği**  
(Liner)

14-635010-00-C  
B : 90.000  
L : 113.000  
D : 94.500  
C : 87.500

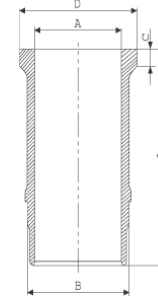

14-635010-00-C

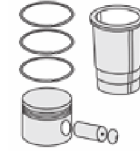

**Silindir Kit**  
(Assembly Set)

88-874300-02-STD  
88-71587-STD

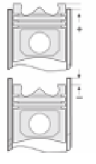

**Piston - Blok Montaj**  
Yüksekliği  
(Piston - Block  
Assembly Height)

