



Motor Özellikleri
(Engine Specifications)

İmalatçı (Manufacturer):
MITSUBISHI
Çap (Diameter): Ø 91,1
FM Grup No: 6003

4 D 56 YENİ TİP
(New Type)

4 Sil. Dizel 2477cc
54 Kw (72 PS)
L 300 YENİ TİP (New Type)
1998....

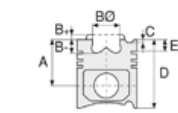

Piston Ölçüleri
(Piston Dimensions)

A : 48.700
B - : 0.200
D : 88.700
E : 16.500

Pim : 29 x 75



Piston Özellikleri
(Piston Features)

Çelik Plaka
(Steel Strut)
Gözarası Konik
(Conical Eye Gap)



Piston Parça No
(Piston Part No)

87-288807-33
87-71590-0501A
0,20 mm Kısa (Short)

87-288000-33
87-71590-STD1A
0,20 mm Kısa (Short)

87-288000-32
87-71590-STD A

87-288007-32
87-71590 050A



Segman Seti
(Ring Set)

06-288000-90-STD
06-288007-90-0,50 mm

2.500 CKP KVI
2.000 CRP STD
4.000 CRP STD



Silindir Gömleği
(Liner)

14-015590-00-D
B : 94.130
L : 164.500

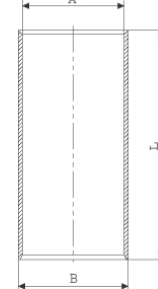

14-015591-00-D
B : 94.630
L : 164.500

Dış Çap 0,50mm Farklı
(Outside Diameter
0.50mm Different)

14-028400-00-D
B : 94.130
L : 164.750
D : 96.000
C : 5.000

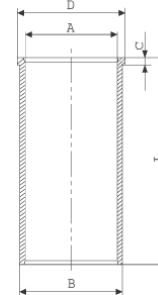

14-028401-00-D
B : 94.630
L : 164.750
D : 96.500
C : 5.000

Dış Çap 0,50mm Farklı
(Outside Diameter
0.50mm Different)

14-028402-00-D
B : 95.130
L : 164.750
D : 97.000
C : 6.000

Dış Çap 1,00mm Farklı
(Outside Diameter
1.00mm Different)

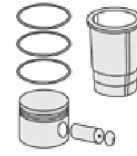

Silindir Kit
(Assembly Set)

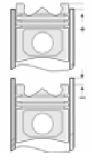

Piston - Blok Montaj
Yüksekliği
(Piston - Block
Assembly Height)

1,35 mm Conta İle
(With Gasket)
+0,55 / +0,61

1,40 mm Conta İle
(With Gasket)
+0,62 / +0,67

1,45 mm Conta İle
(With Gasket)
+0,68 / +0,75

