



MITSUBISHI - Ø 104

87-71594-STD



Motor Özellikleri
(Engine Specifications)

İmalatçı (Manufacturer):
MITSUBISHI
Çap (Diameter): Ø 104
FM Grup No: 6007

4 D 34-OA YENİ TİP
(New Type)

4 Sil. Dizel 3908cc
659 CANTER

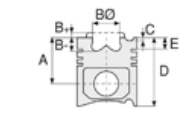

Piston Ölçüleri
(Piston Dimensions)

A : 62.200
B : 20.600
BØ : 52.000
BX : 6.000
BY : 1.800
D : 112.200
E : 16.600

Pim : 34 x 84



Piston Özellikleri
(Piston Features)

Segman Taşıyıcı
(Ring Carrier)
Çelik Plaka
(Steel Strut)
Yağ Püskürtme Oyuğu
(Oil Jet Cut-Out)
Gözarası Konik
(Conical Eye Gap)



Piston Parça No
(Piston Part No)

87-288300-42
87-71594-STD

87-288307-42
87-71594-050

87-288300-43
87-71594-STD1
0,20 mm Kısa (Short)



Segman Seti
(Ring Set)

06-288300-00-STD
06-288307-00-0,50 mm

3.000 CRP KV1
2.000 CRP IKA
4.000 CRP STD



Silindir Gömleği
(Liner)

14-015400-00-D
B : 108.010
L : 197.400

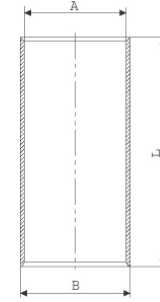

14-015401-00-D
B : 108.510
L : 197.400

Dıştan 0,50 mm Farklı
(0.50 mm Different
From The Outside)

14-020470-10-D
B : 108.010
L : 197.400
D : 110.200
C : 5.000

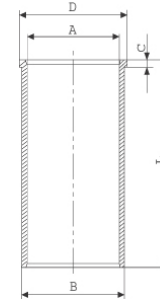

14-020471-10 D
B : 108.510
L : 197.400
D : 110.500
C : 5.500

Dış Çap 0,50mm Farklı
(Outside Diameter
0.50mm Different)

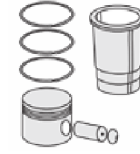

Silindir Kit
(Assembly Set)

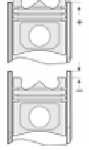

Piston - Blok Montaj
Yüksekliği
(Piston - Block
Assembly Height)

+0,60 / +0,70

