



MITSUBISHI - Ø 104

87-71600-STD



**Motor Özellikleri**  
(Engine Specifications)

İmalatçı (Manufacturer):  
MITSUBISHI  
Çap (Diameter): Ø 104  
FM Grup No: 6014

**4 D 32-2A**  
4 Sil. Dizel 3567cc 69  
Kw (94 PS) CANTER FE 515,  
CANTER FE 635  
2000...

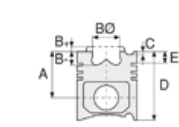

**Piston Ölçüleri**  
(Piston Dimensions)

A : 60.730  
B : 18.900  
B0 : 52.000  
BX : 6.000  
BY : 1.600  
D : 110.730  
E : 16.600

Pim : 34 x 84



**Piston Özellikleri**  
(Piston Features)

Segman Taşıyıcı  
(Ring Carrier)  
Çelik Plaka  
(Steel Strut)  
Gözarası Konik  
(Conical Eye Gap)



**Piston Parça No**  
(Piston Part No)

87-288300-62  
87-71600-STD  
  
87-288307-62  
87-71600-050



**Segman Seti**  
(Ring Set)

06-288300-00-STD  
06-288307-00-0,50 mm  
  
3.000 CRP KV1  
2.000 CRP IKA  
4.000 CRP STD



**Silindir Gömleği**  
(Liner)

14-010260-00-D  
B : 108.010  
L : 191.000

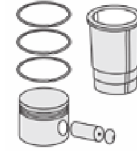
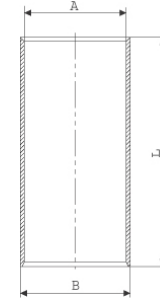

**Silindir Kit**  
(Assembly Set)

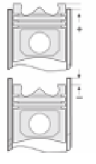

**Piston - Blok Montaj**  
Yüksekliği  
(Piston - Block  
Assembly Height)

