



Motor Özellikleri
(Engine Specifications)

İmalatçı (Manufacturer):
NISSAN-BMC
Çap (Diameter): Ø 92,9
FM Grup No: 1310

TD 2,5

4 Sil. Dizel 2494cc 56
Kw (75PS) Nissan ile ortak
motor (With Nissan
Common Engine)

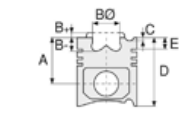

Piston Ölçüleri
(Piston Dimensions)

A : 50.300
B- : 1.500
C1 : 0.500
C2 : 0.800
D : 87.000
E : 15.000

Pim : 28 x 80



Piston Özellikleri
(Piston Features)

Segman Taşıyıcı
(Ring Carrier)
Çelik Plaka
(Steel Strut)
Gözarası Düz
(Flat Eye Gap)

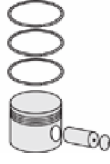

Piston Parça No
(Piston Part No)

87-295500-02
87-71647-STD



Segman Seti
(Ring Set)

06-295500-00-STD
2.500 CRP KV1
2.000 CRP KV1
4.000 CRP STD



Silindir Gömleği
(Liner)

14-020430-00-D
B : 96.000
L : 160.000
D : 102.000
C : 5.000

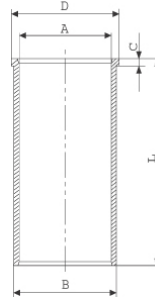

14-029500-00-DH
B : 95.900
L : 160.000
D : 102.000
C : 5.000

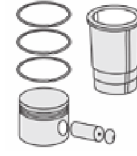
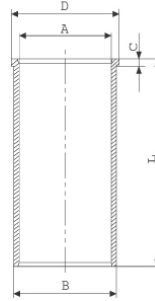

Silindir Kit
(Assembly Set)

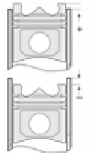

Piston - Blok Montaj
Yüksekliği
(Piston - Block
Assembly Height)

+0,11 / +0,16

