



RENAULT - Ø 86

87-71822-STD A



Motor Özellikleri
(Engine Specifications)

İmalatçı (Manufacturer):
Renault
Çap (Diameter): 86
FM Grup No: 7219

J 8 S.760
4 Sil. Dizel 2068cc
62/65,5 Kw (85/88 PS)
21,5:1
Turbo
ESPACE, MASTER, R 21
Turbo D/DX, R 25,
SAFRANE, TRAFFIC
1992 - 1996

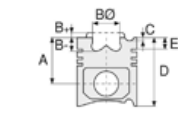

Piston Ölçüleri
(Piston Dimensions)

A : 51.010
B- : 2.000
C1 : 0.330
D : 84.000
E : 13.000

Pim: 28 x 67,9



Piston Özellikleri
(Piston Features)

Segman Taşıyıcı
(Ring Carrier)
Çelik Plaka
(Steel Strut)
Yağ Püskürtme Oyuğu
(Oil Jet Cut-out)
Gözarası Düz
(Flat Eye Gap)



Piston Parça No
(Piston Part No)

87-337000-12
87-71822-STD A



Segman Seti
(Ring Set)

06-337000-90-STD

2.500  CKP KV4
2.500  P F14
3.000  CRP STD



Silindir Gömleği
(Liner)

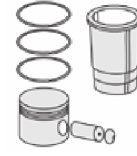

Silindir Kit
(Assembly Set)

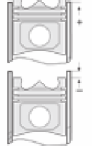

Piston - Blok Montaj
Yüksekliği
(Piston - Block
Assembly Height)

