

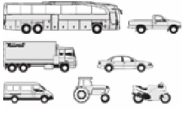

RENAULT - Ø 75,8

87-71835-STD



Motor Özellikleri
(Engine Specifications)

İmalatçı (Manufacturer):
RENAULT
Çap (Diameter): Ø 75,8
FM Grup No: 7208

E5F A 710

4 Sil. Benzinli 1171cc 44
Kw (60 PS) 9, 25:1
Katalizörlü (With
Catalyst) CLIO 1.2 RL,
RN,RT
1991 - 1998

E7F 708

4 Sil. Benzinli 1171cc 44
Kw (60 PS) 9,5:1
Katalizörlü (With
Catalyst) CLIO1,2
RL-RN-RT
1991...

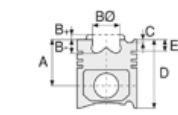

Piston Ölçüleri
(Piston Dimensions)

A : 35.100
B- : 1.200
D : 56.600
E : 7.300

Pim : 19 x 60



Piston Özellikleri
(Piston Features)

Çelik Plaka
(Steel Strut)
Biyel Koluna Sıkı Geçme
(Close-Fit to Connecting Rod)
Gözarası Düz
(Flat Eye Gap)



Piston Parça No
(Piston Part No)

87-336400-42
87-71835-STD



Segman Seti
(Ring Set)

06-336400-20-STD
1.500 CRP IKA
1.750 P STD
3.000 CRP STD



Silindir Gömleği
(Liner)

14-638390-00-WH
B : 80.600
L : 130.000
D : 90.200
C : 91.500

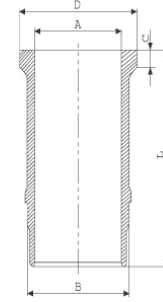

O-RING BİLGİ
(O-ring Information)
50-324418-00
1x 77,2*1,25 MVQ

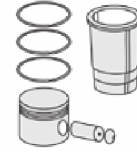

Silindir Kit
(Assembly Set)

88-336400-42-STD
88-71835-STD

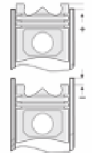

Piston - Blok Montaj
Yüksekliği
(Piston - Block
Assembly Height)

