



RENAULT - Ø 70

87-71840-STD



Motor Özellikleri
(Engine Specifications)

İmalatçı (Manufacturer):
RENAULT
Çap (Diameter): Ø 70
FM Grup No: 7201

C1/J 688

4 Sil. Benzinli 1108cc 39
Kw (53 PS) 9/9,25/9,5:1
R 1227, R 1397, R 2387,
R4 2430, R4 BREAK LONG,
R4 F6R 2370,
R4 FOURGON NETTA,
R5 LAUREATE TL/GTL,
R5 SOCIETE R 2387,
R5 TL/GTL/AUTOMAT,
RA GTL R 1228
1976 - 1990

688 10/11/13

4 Sil. Benzinli 1108cc 8,3:1
RGL/TL R 1181 (6CV),
RODEO 6 ACL 2 B
1971 - 1980

688 01/03

4 Sil. Benzinli 1108cc 8,5:1
FLORIDE-CARAVELLE,
R 10 1100, R 1130, R 1131,
R 1132, R 1133, R 1136,
R 1190, R 8 S, R 8/
R 8 MAJOR
1961...

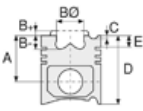

Piston Ölçüleri
(Piston Dimensions)

A : 40.000
D : 68.000
E : 7.750

Pim : 18 x 62



Piston Özellikleri
(Piston Features)

Biyel Koluna Sıkı Geçme
(Close-Fit to Connecting Rod)
Gözarası Düz
(Flat Eye Gap)

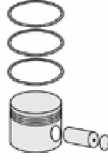

Piston Parça No
(Piston Part No)

87-334600-02
87-71840-STD



Segman Seti
(Ring Set)

06-334600-50-STD
1.750 CRP IKA
2.000 P STD
3.500 CR ST



Silindir Gömleği
(Liner)

14-636730-00-WH
B : 75.500
L : 135.000
D : 85.700
C : 94.800

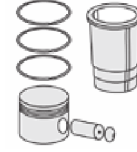
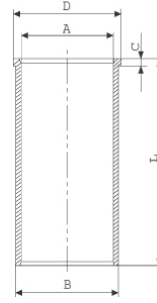

Silindir Kit
(Assembly Set)

88-334600-02-STD
88-71840-STD

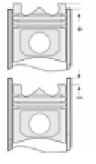

Piston - Blok Montaj
Yüksekliği
(Piston - Block
Assembly Height)

