



RENAULT - Ø 79,5

87-71942-STD



Motor Özellikleri
(Engine Specifications)

İmalatçı (Manufacturer):
RENAULT
Çap (Diameter): Ø 79,5
FM Grup No: 7239

K4J 730/732/740

4 Sil. Benzinli 1390cc 72
KW (98 PS) 10:1
Megane II, SCENIC II 16v
2004...

K4J 710/711/712/715

4 Sil. Benzinli 1390cc 72
KW (98 PS) 10:1 Clio II 16v
2004...

K4J 780

4 Sil. Benzinli 1390cc 72
KW (98 PS) 10:1
Clio III 16v

K4J 770 / 780

4 Sil. Benzinli 1390cc 72
KW (98 PS) 10:1
Modüs 16v
2004...

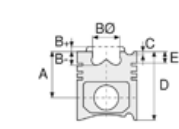

Piston Ölçüleri
(Piston Dimensions)

A : 37.200
C1 : 1.300
C2 : 2.100
D : 64.500
E : 6.000

Pim : 20 x 62



Piston Özellikleri
(Piston Features)

Biyel Koluna Sıkı Geçme
(Close-Fit to Connecting Rod)
Gözarası Düz
(Flat Eye Gap)

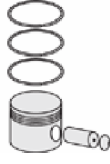

Piston Parça No
(Piston Part No)

87-887400-22
87-71942-STD
87-887407-22
87-71942-050



Segman Seti
(Ring Set)

06-887400-50-STD
06-887407-50-0,50 mm
1.500 CKP KV1
1.500 P GOE44
2.500 CRP ST



Silindir Gömleği
(Liner)

14-022340-00-D
B : 82.500
L : 129.000
D : 84.000
C : 5.000

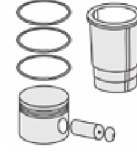
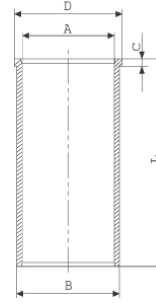

Silindir Kit
(Assembly Set)

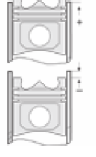

Piston - Blok Montaj
Yüksekliği
(Piston - Block
Assembly Height)

