



MERCEDES BENZ PKW - Ø 88

87-72599-STD



**Motor Özellikleri**  
(Engine Specifications)

İmalatçı (Manufacturer):  
MERCEDES BENZ PKW  
Çap (Diameter): Ø 88  
FM Grup No: 5869

**OM 611 DE 22LA**

4 Sil. Dizel 2151cc 85-115  
Kw(116/156 PS) 18:1  
Turbo ,Intercool,  
Common Rail C200 CDI,  
C220 CDI, E200 CDI,  
E220 CDI , SPRINTER CDI,  
V200 CDI, V220CDI,  
VITO CDI  
1996 - 2000

**OM 611.980 Euro 3**

4 Sil. Dizel 2151cc 60-90  
Kw(82-122 Ps) 18:1  
Turbo,Intercooler,  
Common Rail Vito  
108/110/112 CDI  
1993 - 2003

**Piston Ölçüleri**  
(Piston Dimensions)

A : 42.300  
B- : 13.300  
BØ : 43.100  
C1 : 1.910  
C2 : 2.420  
D : 72.300  
E : 10.200

Pim : 28 x 70

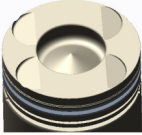

**Piston Özellikleri**  
(Piston Features)

Segman Taşıyıcı  
(Ring Carrier)  
Soğutma Kanallı  
(Cooling Gallery)  
Gözarası Konik  
(Conical Eye Gap)

**Piston Parça No**  
(Piston Part No)

87-117900-22  
87-72599-STD  
87-117907-22  
87-72599-050  
87-117911-22  
87-72599-1,00

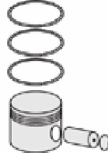

**Segman Seti**  
(Ring Set)

06-117900-00-STD  
06-117907-00-0,50 mm  
06-117911-00-1,00 mm

2.500 CKP KV4  
2.000 P IKA  
3.000 CRP STD  
Goetze® LKZ-Ring®



**Silindir Gömleği**  
(Liner)

14-020300-00-D  
B : 91.000  
L : 147.000  
D : 93.000  
C : 5.000

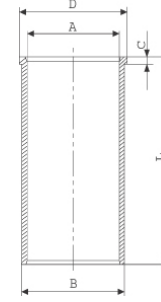

14-020301-00-D  
B : 91.500  
L : 147.000  
D : 93.500  
C : 5.500

Dış Çap 0,50mm Farklı  
(Outside Diameter  
0.50mm Different)

**Silindir Kit**  
(Assembly Set)

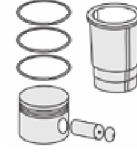

**Piston - Blok Montaj**  
Yüksekliği  
(Piston - Block  
Assembly Height)

+0,38 / +0,62

