



IVECO LKW - Ø 120

87-70757-STD A



Motor Özellikleri
(Engine Specifications)

İmalatçı (Manufacturer):
IVECO LKW
Çap (Diameter): Ø 120
FM Grup No: 4060

8460.41.320.406
C/K/L/R

6 Sil. Dizel 9500cc
276 Kw(375 PS) 17:1
Turbo intercool
EUROTECH-180 E 30R,
180 E 3R, 190 E 30,
190 E 38, 240 E 38,
440 E 38P, 440 E 38T,
EUROTRAKKER 380
E 34H, MT 180 E 34,
MT 400 E 34
1991....

8460.21B.613/615

6 Sil. Dizel 9500cc
180 E30, 180 E34,
190 E30, 240 E 38,
380 E34, 400 E34,
400 E38, 440 E38,
480 TURBOCITY,
490, 5522, 580
TURBOCITY, 590 E22
1988....

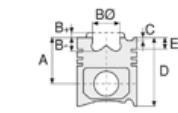

Piston Ölçüleri
(Piston Dimensions)

A : 84.700
B- : 27.000
BØ : 60.000
C1 : 3.180
D : 134.700
E : 9.500

Pim: 48 x 108

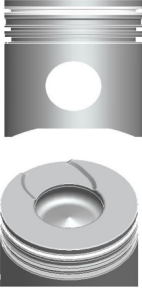

Piston Özellikleri
(Piston Features)

Segman Taşıyıcı
(Ring Carrier)
Soğutma Kanallı
(Coolin Gallery)
Yağ Püskürtme Oyuğu
(Oil Jet Cut-out)
Gözarası Konik
(Conical Eye Gap)

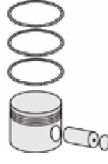

Piston Parça No
(Piston Part No)

87-854900-12
87-70757-STD A

87-785300-02
87-70757-STD B



Segman Seti
(Ring Set)

06-854900-20-STD

3.500 CR KV1
3.000 CR IKA
5.000 CR STD

06-785300-20-STD

3.500 CR KV1
3.000 CR STD
5.000 CR STD



Silindir Gömleği
(Liner)

14-450020-00-WH
B : 134.000
L : 249.250
D : 144.800
C : 10.100
F : 1.000

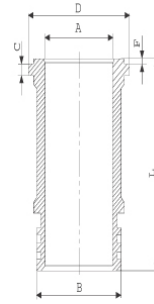

Dış Yüzeyi Fosfat Kaplı
(Outer Surface
Phosphate Coated)

14-450020-00-WH
Dış Yüzeyi Fosfat Kaplı
(Outer Surface
Phosphate Coated)

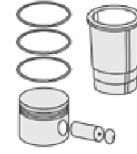

Silindir Kit
(Assembly Set)

88-854900-12-STD
88-70757-STD A

88-785300-02-STD
88-70757-STD B

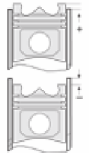

Piston - Blok Montaj
Yüksekliği
(Piston - Block
Assembly Height)

+0,36 / +0,84

