



MITSUBISHI - Ø 91,1

87-71589-STDA



**Motor Özellikleri**  
(Engine Specifications)

İmalatçı (Manufacturer):  
MITSUBISHI  
Çap (Diameter): Ø 91,1  
FM Grup No: 6002

**4 D 56**

4 Sil. Dizel 2477cc 54  
Kw (72 PS) 21:1 Canter,  
Colt, GLANT A 167,  
GLANT SAPPORO,  
L 300, Montero, Pajero  
1986 - 2000

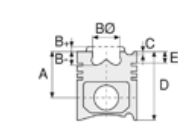

**Piston Ölçüleri**  
(Piston Dimensions)

A : 48.700  
B- : 3.200  
C1 : 2.400  
C2 : 2.700  
D : 88.700  
E : 16.500

Pim : 29 x 75



**Piston Özellikleri**  
(Piston Features)

Çelik Plaka  
(Steel Strut)  
Gözarası Konik  
(Conical Eye Gap)

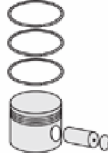

**Piston Parça No**  
(Piston Part No)

87-288000-12  
87-71589-STDA  
87-288007-12  
87-71589-050A



**Segman Seti**  
(Ring Set)

06-288000-90-STD  
06-288007-90-0,50 mm  
2.500 CKP KV1  
2.000 CRP STD  
4.000 CRP STD



**Silindir Gömleği**  
(Liner)

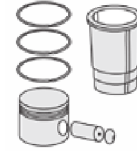

**Silindir Kit**  
(Assembly Set)

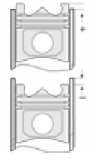

**Piston - Blok Montaj**  
**Yüksekliği**  
(Piston - Block  
Assembly Height)

1,35 mm Conta İle  
(With Gasket)  
+0,55/+0,61  
1,40 mm Conta İle  
(With Gasket)  
+0,62/+0,67  
1,45 mm Conta İle  
(With Gasket)  
+0,68/+0,75

