



SUZUKI - Ø 65,5

87-72051-STDA



Motor Özellikleri
(Engine Specifications)

İmalatçı (Manufacturer):
SUZUKI
Çap (Diameter): Ø 65,5
FM Grup No: 8102

F10A

4 Sil. Benzinli 970cc
33 Kw(45 HP-DIN) 8,8:1
Süper Carry SK 410
1985 - 1993

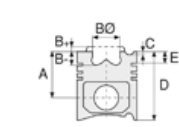

Piston Ölçüleri
(Piston Dimensions)

A : 22.650
B- : 2.200
BØ : 52.500
C1 : 4.200
C2 : 5.500
D : 55.050
E : 4.000

Pim: 16 x 53,5



Piston Özellikleri
(Piston Features)

Gözarası Düz
(Flat Eye Gap)

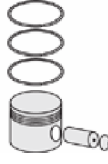

Piston Parça No
(Piston Part No)

87-960200-12
87-72051-STDA

87-960207-12
87-72051 050A



Segman Seti
(Ring Set)

06-960200-30-STD
06-960207-30 0,50 mm

1.500 CRP IKA
1.500 P STD
2.800 CRP STD



Silindir Gömleği
(Liner)

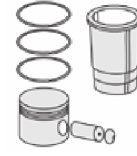

Silindir Kit
(Assembly Set)

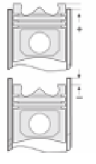

Piston - Blok Montaj
Yüksekliği
(Piston - Block
Assembly Height)

