



Motor Özellikleri
(Engine Specifications)

İmalatçı (Manufacturer):
VOLKSWAGEN
Çap (Diameter): Ø 79,51
FM Grup No: 86118

AQM

4 Sil. Dizel 1896cc
50 Kw(68 PS)
BORA SDI, GOLF SDI,
POLO SDI
1997....

AGP

4 Sil. Dizel 1896cc
50 Kw(68 PS) 19,5:1
BORA SDI, GOLF SDI,
POLO SDI
1997....

ASY

4 Sil. Dizel 1896cc
47 Kw(64 PS) 22.5:1
POLO SDI-
2001....

ASX

4 Sil. Dizel 1896cc
47 Kw(64 PS)
POLO SDI
1999....

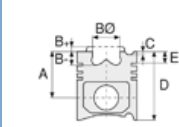

Piston Ölçüleri
(Piston Dimensions)

A : 39.800
B- : 17.750
BØ : 37.950
C1 : 1.000
D : 60.800
E : 6.000

Pim: 24 x 58



Piston Özellikleri
(Piston Features)

Segman Taşıyıcı
(Ring Carrier)
Gözarası Konik
(Conical Eye Gap)

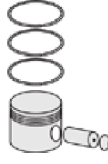

Piston Parça No
(Piston Part No)

87-114900-32
87-72164-STD
1 ve 2. Silindir (Cylinder)

87-114907-32
87-72164-050

87-114900-52
87-72165-STD
3 ve 4. Silindir (Cylinder)

87-114907-52
87-72165-050



Segman Seti
(Ring Set)

06-114900-00-STD
06-114907-00 0,50 mm

1.750 CKP KV1
2.000 P F14
3.000 CRP STD

Goetze® LKZ-Ring®



Silindir Gömleği
(Liner)

14-027950-00-D

B : 82.500
L : 152.000
D : 85.500
C : 4.700

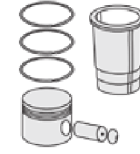
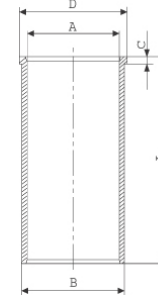

Silindir Kit
(Assembly Set)

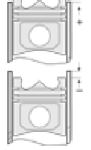

Piston - Blok Montaj
Yüksekliği
(Piston - Block
Assembly Height)

1 Çentik Conta ile
(With Notch Gasket)
0,91/1,00

2 Çentik Conta ile
(With Notch Gasket)
1,01/1,10

3 Çentik Conta ile
(With Notch Gasket)
1,11/1,20

