



VOLVO - Ø 120,65

87-7222-STD



Motor Özellikleri
(Engine Specifications)

İmalatçı (Manufacturer):
VOLVO
Çap (Diameter): Ø 120,65
FM Grup No: 88002

THD100DD

6 Sil. Dizel 9600cc
160/180/193 Kw (217/245/
260 PS) 15:1 Turbo
300CH, 400CH, B10M,
B58, B59, B9M
1975 - 1982

THD100DC

6 Sil. Dizel 9600cc
160/180/193 Kw (217/245
/260 PS) 15:1 Turbo
300CH, 400CH, B10M,
B58, B59, B9M
1975 - 1982

THD100D

6 Sil. Dizel 9600cc
160/180/193 Kw (217/245/
260 PS) 15:1 Turbo
300CH, 400CH, B10M,
B58, B59, B9M
1975 - 1982

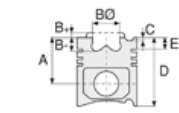

Piston Ölçüleri
(Piston Dimensions)

A : 109.400
B - : 22.200
BØ : 74.000
BX : 4.000
C1 : 1.880
D : 166.400
E : 33.000

Pim : 52 x 105,66



Piston Özellikleri
(Piston Features)

Segman Taşıyıcı
(Ring Carrier)
Gözarası Düz
(Flat Eye Gap)

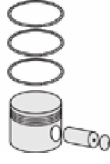

Piston Parça No
(Piston Part No)

87-827200-22
87-72222-STD



Segman Seti
(Ring Set)

06-827200-00-STD
2.385 CRP KV1
3.160 CRP STD
4.747 CRP STD



Silindir Gömleği
(Liner)

14-677620-00-WH
B : 134.000
L : 296.250
D : 147.000
C : 11.530
F : 3.400
R : 14.450

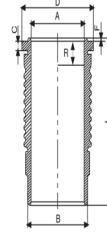

O-RING BİLGİ
(O Ring Information)
24-35030-80/O
1x 132,8*5,8 FPM LILA
1x 132,8*5,8 EPDM
1x 132,5*1,6 FPM

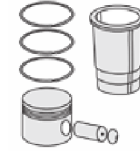

Silindir Kit
(Assembly Set)

89-827200-22-STD
89-72222-STD

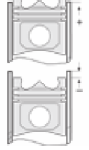

Piston - Blok Montaj
Yüksekliği
(Piston - Block
Assembly Height)

+0,20 / +0,50

14-459350-00-WH
B : 133.860
L : 296.250
D : 147.000
C : 11.530
F : 3.400
R : 14.450

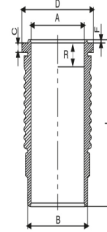

O-RİNG BİLGİ
(O Ring Information)
24-35031-01/O
1x 132,8*5,8 FPM LILA
1x 132,8*5,8 EPDM
1x 132,5*2,4 FPM

89-827200-32-STD
89-72222-STD