



TATA - Ø 75

87-72251-STD



Motor Özellikleri
(Engine Specifications)

İmalatçı (Manufacturer):
TATA
Çap (Diameter): Ø 75
FM Grup No: 9301

475 IDI TCIC EURO III
4 Sil. Dizel 1405cc
70 PS 21:1
INDICA, INDIGO, MARINA

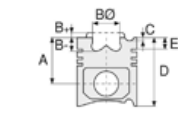

Piston Ölçüleri
(Piston Dimensions)

A : 42.950
B- : 1.900
D : 68.500
E : 9.100

Pim: 25 x 60



Piston Özellikleri
(Piston Features)

Segman Taşıyıcı
(Ring Carrier)
Yağ Püskürtme Oyuğu
(Oil Jet Cut-out)
Gözarası Konik
(Conical Eye Gap)



Piston Parça No
(Piston Part No)

87-859300-02
87-72251-STD



Segman Seti
(Ring Set)

06-859300-90-STD

2.500 CKP KV1
2.000 P F14
3.000 CRP STD



Silindir Gömleği
(Liner)

14-010710-00-D

B : 78.100
L : 136.500

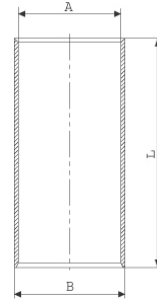

14-021690-00-D

B : 78.100
L : 136.500
D : 79.600
C : 5.000

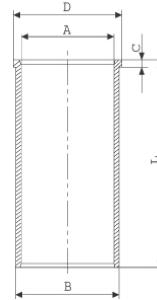

14-021691-00-D

B : 78.600
L : 136.500
D : 80.100
C : 5.500

Dış Çap 0,50 mm
Farklı Yarı Mamul
(Outer Diameter
0.50 mm Different
Semi-finished)

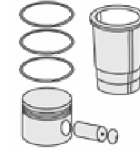

Silindir Kit
(Assembly Set)

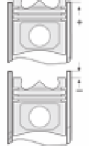

Piston - Blok Montaj
Yüksekliği
(Piston - Block
Assembly Height)

- 1.Kertik Conta ile
(1.With Groove Gasket)
+0,45/+0,55
- 2.Kertik Conta ile
(2.With Groove Gasket)
+0,55/+0,65
- 3.Kertik Conta ile
(3.With Groove Gasket)
+0,65 /+0,75

