



LIEBHERR - Ø 122

87-73190-STD



Motor Özellikleri
(Engine Specifications)

İmalatçı (Manufacturer):
LIEBHERR
Çap (Diameter): Ø 122
FM Grup No: 8921

D 924 / D 926
4 Sil. Dizel 6640cc
66-180KW/
90-245PS 17,2;1

İŞ MAKİNASI
(Working Machine)

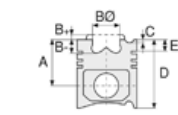

Piston Ölçüleri
(Piston Dimensions)

A : 79.300
B - : 23.000
BØ : 73.000
BX : 3.000
BY : 1.000
D : 124.300
E : 16.000

Pim: 45 x 101



Piston Özellikleri
(Piston Features)

Segman Taşıyıcı
(Ring Carrier)
Yağ Püskürtme Oyuğu
(Oil Spray Groove)
Gözarası düz
(Flat Eye Gap)



Piston Parça No
(Piston Part No)

87-813000-02
87-73190-STD



Segman Seti
(Ring Set)

06-813000-00 STD
3.500 CKS KV1
2.500 CR F14
4.000 CR STD



Silindir Gömleği
(Liner)

14-481050-00-WH
B : 136.000
L : 247.000
D : 149.000
C : 12.010
F : 1.000

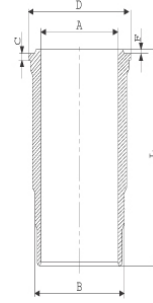

3 Adet O-RİNG Yuvalı
(3 pieces O-RING Slots)
24-35054-30/O
3x126,60*3,53
FKM70 Perox

14-481060-00 WH
B : 130.000
L : 247.000
D : 149.000
C : 12.010
F : 0.750

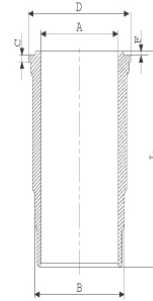

2 Adet O-RİNG Yuvalı
(2 pieces O-RING Slots)
24-35054-30/O
2x126,60*3,53
FKM70 Perox

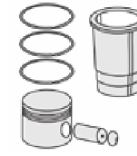

Silindir Kit
(Assembly Set)

88-813000-02-STD
88-73190-STD

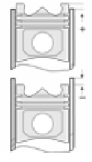

Piston - Blok Montaj
Yüksekliği
(Piston - Block
Assembly Height)

