

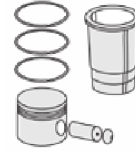

TOYOTA - Ø 96

87-72082-STD

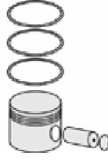

Motor Özellikleri
(Engine Specifications)

İmalatçı (Manufacturer):
TOYOTA
Çap (Diameter): Ø 96
FM Grup No: 8214

1KD-FTV
4 Sil. Dizel 2982cc
75KW-102PS
HILUX VII, LAND
CRUISER
2010...

Piston Ölçüleri
(Piston Dimensions)

A : 49.600
B - : 16.250
BØ : 61.900
C1 : 1.000
C2 : 0.850
D : 78.400
E : 10.100

Pim: 34 x 73

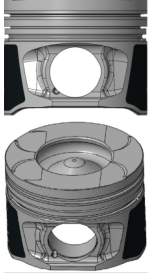

Piston Özellikleri
(Piston Features)

Segman Taşıyıcı
(Ring Carrier)
Soğutma Kanallı
(Coolin Gallery)
Gözarası Konik
(Conical Eye Gap)

Piston Parça No
(Piston Part No)

87-894700-02
87-72082-STD
87-894707-02
87-72082 0,50

Segman Seti
(Ring Set)

06-894700-20-STD
06-894707-20 0,50
2.000 NT ST
1.500 NT ST
3.000 NT ST

Silindir Gömleği
(Liner)

Silindir Kit
(Assembly Set)

Piston - Blok Montaj
Yüksekliği
(Piston - Block
Assembly Height)

