



PEUGEOT - Ø 94

87-71767-STD



**Motor Özellikleri**  
(Engine Specifications)

İmalatçı (Manufacturer):  
PEUGEOT  
Çap (Diameter): Ø 94  
FM Grup No: 7122

**XD 3 P**  
4 Sil. Dizel 2498cc  
51,5/53/56  
Kw (70/73/76 PS) 23:1  
505 GRD/SRD,  
Famielle D, j 9 Minübüs  
1982...

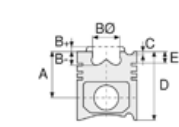

**Piston Ölçüleri**  
(Piston Dimensions)

A : 53.920  
B - : 1.750  
D : 91.420  
E : 15.000

Pim : 30 x 78,8

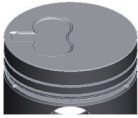

**Piston Özellikleri**  
(Piston Features)

Gözarası Düz  
(Flat Eye Gap)



**Piston Parça No**  
(Piston Part No)

87-318700-42  
87-71767-STD  
87-318707-42  
87-71767-050

87-884300-02  
87-71767-STDA

87-884000-02  
87-71767-STDB



**Segman Seti**  
(Ring Set)

06-318700-10-STD  
06-318706-10-0,40 mm  
06-318707-10-0,50 mm  
06-318708-10-0,60 mm  
06-318711-10-1,00 mm

2.000 CRP KVI  
2.000 P STD  
4.000 CRP STD

06-884306-00-0,40 mm  
06-884308-00-0,60 mm  
06-884311-00-1,00 mm

06-884006-00-0,40 mm  
06-884008-00-0,60 mm  
06-884011-00-1,00 mm



**Silindir Gömleği**  
(Liner)

14-020660-00-D  
B : 97.000  
L : 170.600  
D : 99.500  
C : 4.000

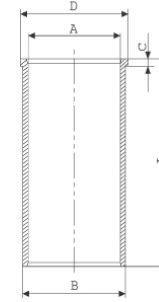

14-021520-00-D  
B : 98.000  
L : 170.600  
D : 100.000  
C : 6.000

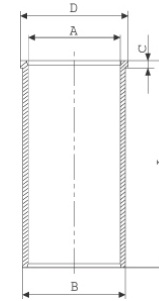

Dış çap 1,0 mm farklı  
(Outer Diameter  
1.00 mm Different)

14-029010-00 D  
B : 98.000  
L : 166.600  
D : 100.000  
C : 6.000

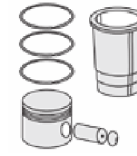
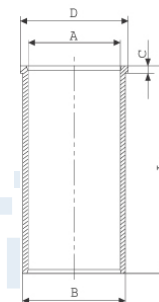

**Silindir Kit**  
(Assembly Set)

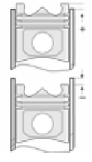

**Piston - Blok Montaj**  
Yüksekliği  
(Piston - Block  
Assembly Height)

1,56mm Cont (Count)  
..... / + 0,84

1,70mm Cont (Count)  
..... / + 0,84





**Motor Özellikleri**  
(Engine Specifications)

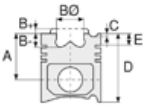

**Piston Ölçüleri**  
(Piston Dimensions)



**Piston Parça No**  
(Piston Part No)



**Segman Seti**  
(Ring Set)



**Silindir Gömleği**  
(Liner)

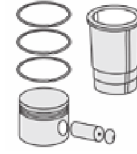

**Silindir Kit**  
(Assembly Set)

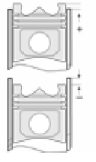

**Piston - Blok Montaj**  
**Yüksekliği**  
(Piston - Block  
Assembly Height)

4,00 mm Kısa ve  
Dış Çap 1,00mm Farklı  
(Short and Outer  
Diameter 1.00mm  
Different)

14-029020-00-D  
B : 97.000  
L : 166.600  
D : 99.500  
C : 4.000

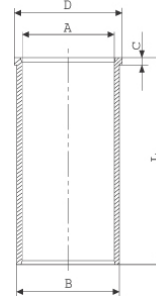

4,00 mm Kısa (Short)

14-029021-00-D  
B : 97.500  
L : 166.600  
D : 100.000  
C : 4.000

Dış Çap 0,50mm Farklı  
(Outside Diameter  
0.50mm Different)

