

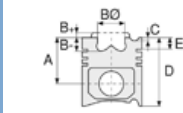

Motor Özellikleri
(Engine Specifications)

İmalatçı (Manufacturer):
PERKINS LKW
Çap (Diameter): Ø 100
FM Grup No: 6917

BH 509 PHASER 90
6 Sil. Dizel 4000cc 65
Kw (89 PS)
PD 250 AS, PD 250
AS SUPER, PW 250 (4X4)



Piston Ölçüleri
(Piston Dimensions)

A : 70.140
B- : 20.140
BØ : 55.300
BX : 3.200
D : 108.140
E : 10.140

Pim: 34,925 x 84,1

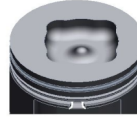

Piston Özellikleri
(Piston Features)

Segman Taşıyıcı
(Ring Carrier)
Çelik Plaka
(Steel Strut)
Gözarası Konik
(Conical Eye Gap)



Piston Parça No
(Piston Part No)

87-880600-33
87-73546-STD1A
0.14 mm Kısa (Short)
87-880600-34
87-73546-STD2A
0.30 mm Kısa (Short)
87-880600-32
87-73546-STD A



Segman Seti
(Ring Set)

06-880600-90-STD
2.500 CKP KV1
2.500 P IKA
4.000 CRP STD
Goetze® LKZ-Ring®



Silindir Gömleği
(Liner)

14-025380-00-DH
B : 104.200
L : 226.500
D : 107.400
C : 3.850

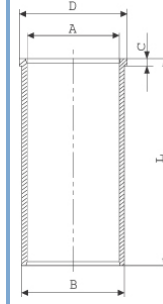

14-026751-00-D

B : 104.700
L : 226.500
D : 107.400
C : 4.000

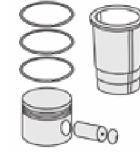
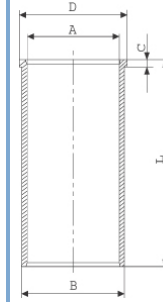

Silindir Kit
(Assembly Set)

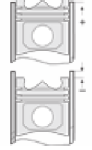

Piston - Blok Montaj
Yüksekliği
(Piston - Block
Assembly Height)

+ 0,135 / + 0,363





Motor Özellikleri
(Engine Specifications)

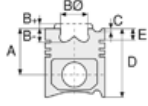

Piston Ölçüleri
(Piston Dimensions)

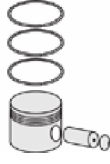

Piston Parça No
(Piston Part No)



Segman Seti
(Ring Set)



Silindir Gömleği
(Liner)

14-027850-00-D

B : 104.255
L : 227.400
D : 107.700
C : 4.000

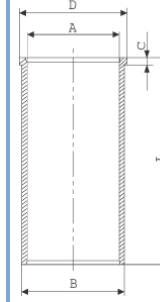

14-027851-10-D

B : 105.255
L : 227.400
D : 107.700
C : 4.000

Dış Çap 1,00mm Farklı
(Outer Diameter
1,00 mm Different)

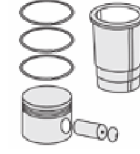

Silindir Kit
(Assembly Set)

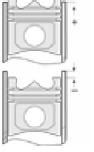

Piston - Blok Montaj
Yüksekliği
(Piston - Block
Assembly Height)

