



Motor Özellikleri
(Engine Specifications)

İmalatçı (Manufacturer):
Cummins
Çap (Diameter): 114
FM Grup No: 2118

ISLe375 20 Euro2
6 Sil. Dizel 8900cc
276 Kw (375 Ps) 16,6:1
Dongfeng 375, PRO 935

Piston Ölçüleri
(Piston Dimensions)

A : 74.300
B- : 22.300
BØ : 67.700
C1 : 1.000
D : 105.400
E : 8.500

Pim: 45 x 91



Piston Özellikleri
(Piston Features)

Yağ Püskürtme Oyuğu
(Oil Jet Cut-out)
Gözarası Konik
(Conical Eye Gap)



Piston Parça No
(Piston Part No)

87-819600-02
87-75006-STD
Çift parçalı Piston
(Articulated)



Segman Seti
(Ring Set)

06-819600-00-STD
3.500 CRP KV1
3.000 P F14
4.000 CRP STD

Goetze® LKZ-Ring®



Silindir Gömleği
(Liner)

14-022100-00-D
B : 110.000
L : 202.000
D : 111.500
C : 5.000

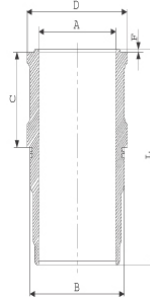

O-RING BİLGİ
(O-Ring Information)
50-35047-60/O
1x 120*124*4 FPM

14-749630-00-WH
O-RING BİLGİ
(O-Ring Information)
50-35047-60/O
1x 120*124*4 FPM

14-749632-00-WH
B : 125.685
L : 235.370
D : 130.948
C : 124.550
F : 1.250

C: 1,50 mm Uzun (Long)

14-749633-00-WH
B : 125.685
L : 235.370
D : 130.948
C : 126.050
F : 1.250

C: 3,00 mm Uzun (Long)

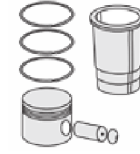

Silindir Kit
(Assembly Set)

89-819600-02-STD
89-75006 STD

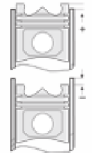

Piston - Blok Montaj
Yüksekliği
(Piston - Block
Assembly Height)

+0,15/+0,48





Motor Özellikleri
(Engine Specifications)



Piston Ölçüleri
(Piston Dimensions)

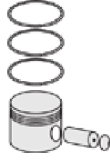

Piston Parça No
(Piston Part No)



Segman Seti
(Ring Set)



Silindir Gömleği
(Liner)

14-749640-00-WH
B : 125.685
L : 235.370
D : 131.200
C : 124.250
F : 1.250

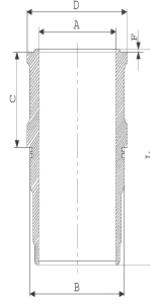

C:1,20 mm Uzun (Long)

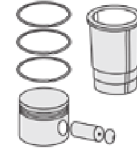

Silindir Kit
(Assembly Set)

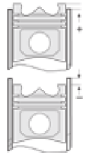

Piston - Blok Montaj
Yüksekliği
(Piston - Block
Assembly Height)

