



CLAAS - Ø 130

87-72563-STD



Motor Özellikleri
(Engine Specifications)

İmalatçı (Manufacturer):
CLAAS
Çap (Diameter): Ø 130
FM Grup No: 9102

OM 541.991
OM 501 LA
V6 Sil / V8 Sil Dizel
300 kW / 408 PS
11946
ACTROS
II-TRAVEGO-SETRA /
CLAAS SİLAJ MAKİNASI
1998 -

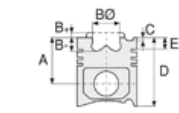

Piston Ölçüleri
(Piston Dimensions)

A : 78.55
B- : 14.970
BØ : 110.000
D : 119.550
E : 15.000

Pim : 52 x 103

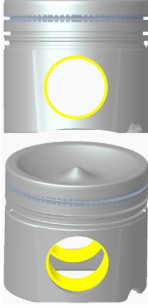

Piston Özellikleri
(Piston Features)

Bronz Burç
(Bronze Bush)
Yağ Püskürtme Oyuğu
(Oil Jet Cut-out)
Gözarası Konik
(Conical Eye Gap)



Piston Parça No
(Piston Part No)

87-136000-72
87-72563-STD



Segman Seti
(Ring Set)

06-136000-20-STD
3.000  CK ST
3.000  CR GOE
4.000  CK KV1
Goetze® LKZ-Ring® /
Yağ Segmanı Matkap Delik
(Oil Ring Drill Hole)



Silindir Gömleği
(Liner)

14-451220-00-WH
B : 150.000
L : 258.000
D : 164.200
C : 10.120
F : 1.100
R : 13.500

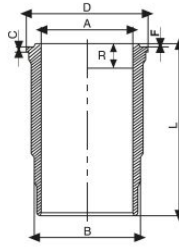

KURUM GİDERME
RİNGLİ
(With Scraper Rings)
/ O-RING BİLGİ
(O-ring Information)
24-35048-60/O
2x 149x158,6x7 FPM
1x 153*163*0,15 SHIM

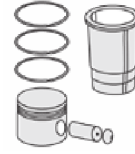

Silindir Kit
(Assembly Set)

89-72563-STD
89-136000-72-STD

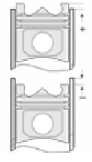

Piston - Blok Montaj
Yüksekliği
(Piston - Block
Assembly Height)

