



HYUNDAI - Ø 71

87-71176-STD



**Motor Özellikleri**  
(Engine Specifications)

İmalatçı (Manufacturer):  
HYUNDAI  
Çap (Diameter): Ø 71  
FM Grup No: 3626

**G4LA**

4 Sil. Benzinli 1248cc 57  
KW-78 PS 10, 5:1  
İ 10 1.2 16V, İ 20 1.2 16V  
2008...

**Piston Ölçüleri**  
(Piston Dimensions)

A : 24.700  
C1 : 2.820  
C2 : 2.670  
D : 43.900  
E : 5.100

Pim : 18 x 48



**Piston Özellikleri**  
(Piston Features)

Biyel Koluna Sıkı Geçme  
(Close-Fit To Connecting Rod)  
Gözarası Düz  
(Flat Eye Gap)

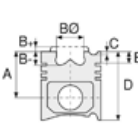

**Piston Parça No**  
(Piston Part No)

87-851100-02  
87-71176-STD  
ESKİ KOD (Old Code):  
87-71122-STD  
87-851107-02  
87-71176-0,50



**Segman Seti**  
(Ring Set)

06-851100-50-STD  
06-851107-50-0,50 mm

1.000 CR ST  
1.200 P GOE  
2.000 CR ST



**Silindir Gömleği**  
(Liner)

14-011500-00-DH  
B : 71.000  
L : 115.000  
D : 74.000

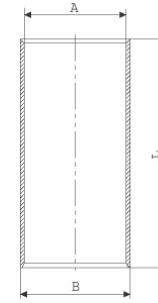

**Silindir Kit**  
(Assembly Set)

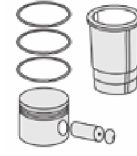

**Piston - Blok Montaj**  
Yüksekliği  
(Piston - Block  
Assembly Height)

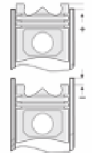



HYUNDAI - Ø 71,5

87-71126-STD



**Motor Özellikleri**  
(Engine Specifications)

İmalatçı (Manufacturer):  
HYUNDAI  
Çap (Diameter): Ø 71,5  
FM Grup No: 3601

**G4EH**  
4 Sil. Benzinli 1300cc  
ACCENT 1.3  
1995 - 1998

**Piston Ölçüleri**  
(Piston Dimensions)

A : 31.300  
B- : 1.100  
BØ : 59.000  
C1 : 2.000  
D : 54.400  
E : 5.100

Pim : 18 x 47,5



**Piston Özellikleri**  
(Piston Features)

Biyel Koluna Sıkı Geçme  
(Close-Fit To Connecting Rod)  
Gözarası Düz  
(Flat Eye Gap)

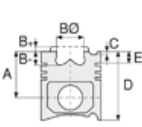

**Piston Parça No**  
(Piston Part No)

87-847600-02  
87-71126-STD  
87-847607-02  
87-71126-050

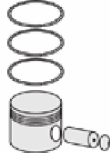

**Segman Seti**  
(Ring Set)

06-847600-00-STD  
06-847607-00-0,50 mm  
1.500 CRP KV1  
1.500 P STD  
3.000 CRP STD



**Silindir Gömleği**  
(Liner)

14-022030-00-D  
B : 74.500  
L : 132.000  
D : 76.000  
C : 5.000



**Silindir Kit**  
(Assembly Set)

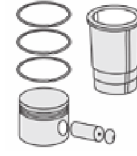

**Piston - Blok Montaj**  
Yüksekliği  
(Piston - Block  
Assembly Height)

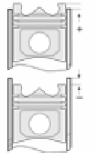



HYUNDAI - Ø 71,5

87-71127-STD



**Motor Özellikleri**  
(Engine Specifications)

İmalatçı (Manufacturer):  
HYUNDAI  
Çap (Diameter): Ø 71,5  
FM Grup No: 3607

**G4K**  
4 Sil. Benzinli 1300cc 75 Ps  
ACCENT 1,3 MİLENYUM  
2000...

**Piston Ölçüleri**  
(Piston Dimensions)

A : 30.800  
B : 0.700  
BØ : 57.900  
C1 : 2.200  
D : 53.900  
E : 5.100

Pim : 18 x 47,5



**Piston Özellikleri**  
(Piston Features)

Biyel Koluna Sıkı Geçme  
(Close-Fit To Connecting Rod)  
Gözarası Düz  
(Flat Eye Gap)



**Piston Parça No**  
(Piston Part No)

87-848600-02  
87-71127-STD  
87-848607-02  
87-71127-050



**Segman Seti**  
(Ring Set)

06-848600-50-STD  
06-848607-50-0,50 mm  
1.500 CRP KV1  
1.500 P STD  
3.000 CR ST



**Silindir Gömleği**  
(Liner)

14-022030-00-D  
B : 74.500  
L : 132.000  
D : 76.000  
C : 5.000

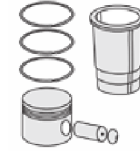
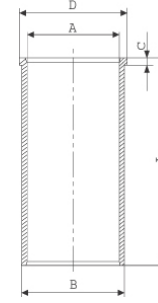

**Silindir Kit**  
(Assembly Set)

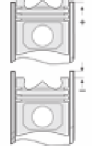

**Piston - Blok Montaj**  
Yüksekliği  
(Piston - Block  
Assembly Height)





HYUNDAI - Ø 72

87-71177-STD



**Motor Özellikleri**  
(Engine Specifications)

İmalatçı (Manufacturer):  
HYUNDAI  
Çap (Diameter): Ø 72  
FM Grup No: 3633

**G4LC**

4 Sil. Benzinli 1368cc 74-76  
KW / 101-103PS  
ACCENT , ACCENT BLUE,  
i 20, i 20 Coupe, i 30,  
i 30 CW  
2014...

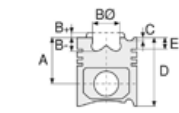

**Piston Ölçüleri**  
(Piston Dimensions)

A : 24.700  
B- : 3.600  
C1 : 2.500  
D : 42.700  
E : 5.500

Pim : 18 x 48



**Piston Özellikleri**  
(Piston Features)

Biyel Koluna Sıkı Geçme  
(Close-Fit To Connecting Rod)  
Gözarası Konik  
(Conical Eye Gap)

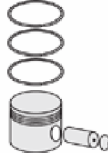

**Piston Parça No**  
(Piston Part No)

87-851200-02  
87-71177-STD  
ESKİ KOD (Old Code):  
87-71123-STD  
87-851207-02  
87-71177-0,50



**Segman Seti**  
(Ring Set)

06-851200-50-STD  
06-851207-50-0,50 mm

1.000  CR ST  
1.200  P GOE  
2.000  CR ST



**Silindir Gömleği**  
(Liner)

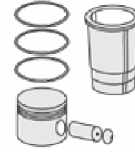

**Silindir Kit**  
(Assembly Set)

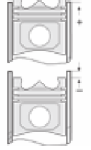

**Piston - Blok Montaj**  
Yüksekliği  
(Piston - Block  
Assembly Height)







**Motor Özellikleri**  
(Engine Specifications)

İmalatçı (Manufacturer):  
KIA-HYUNDAI  
Çap (Diameter): Ø 75  
FM Grup No: 3616

**D4FA C.Rail**  
4 Sil. Dizel 1493cc 81KW  
(110 Ps) 17.8:1  
ACCENT ERA 16V  
2005...

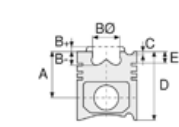

**Piston Ölçüleri**  
(Piston Dimensions)

A : 41.950  
B - : 12.200  
BØ : 43.400  
C1 : 0.500  
D : 65.700  
E : 9.200

Pim : 28 x 62



**Piston Özellikleri**  
(Piston Features)

Segman Taşıyıcı  
(Ring Carrier)  
Soğutma Kanallı  
(Cooling Gallery)  
Yağ Püskürtme Oyuğu  
(Oil Jet Cut-Out)  
Gözarası Düz  
(Flat Eye Gap)



**Piston Parça No**  
(Piston Part No)

87-849000-02  
87-71128-STD  
87-849007-02  
87-71128-050



**Segman Seti**  
(Ring Set)

06-849000-00-STD  
06-849007-00-0,50 mm  
1.750 CK ST  
1.750 CRP KV1  
3.000 NT ST



**Silindir Gömleği**  
(Liner)

14-022020-00-D  
B : 78.500  
L : 143.000  
D : 79.500  
C : 5.000

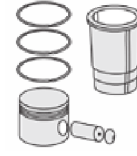
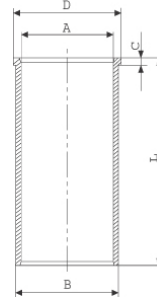

**Silindir Kit**  
(Assembly Set)

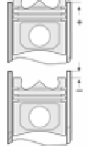

**Piston - Blok Montaj**  
**Yüksekliği**  
(Piston - Block  
Assembly Height)

1-1,15 mm Conta İle  
(With Gasket)  
0,035 / 0,105

1,05-1,20 mm Conta İle  
(With Gasket)  
0,105 / 0,175

1,10-1,25 mm Conta İle  
(With Gasket)  
0,175 / 0,245





HYUNDAI - Ø 75

87-71129-STD



**Motor Özellikleri**  
(Engine Specifications)

İmalatçı (Manufacturer):  
HYUNDAI  
Çap (Diameter): Ø 75  
FM Grup No: 3628

**D4FC**

4 Sil. Dizel 1396cc 90  
ACCENT 1.4 CRDi, İ20  
1.4 CRDi, İX20 1.4 CRDi  
2011...

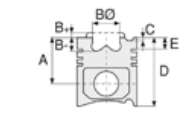

**Piston Ölçüleri**  
(Piston Dimensions)

A : 44.700  
B - : 11.800  
BØ : 43.400  
C1 : 0.500  
D : 68.500  
E : 9.200

Pim : 28 x 62



**Piston Özellikleri**  
(Piston Features)

Segman Taşıyıcı  
(Ring Carrier)  
Sert Anotlama  
(Hard Anodizing)  
Soğutma Kanallı  
(Cooling Gallery)  
Yağ Püskürtme Oyuğu  
(Oil Jet Cut-Out)  
Gözarası Düz  
(Flat Eye Gap)

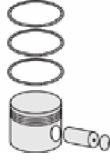

**Piston Parça No**  
(Piston Part No)

87-849600-02  
87-71129-STD  
87-849607-02  
87-71129-0,50



**Segman Seti**  
(Ring Set)

06-849600-00-STD  
06-849607-00-0,50 mm  
1.750 NT ST  
1.750 CR KVI  
3.000 NT ST



**Silindir Gömleği**  
(Liner)

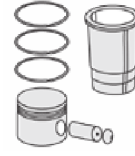

**Silindir Kit**  
(Assembly Set)

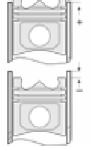

**Piston - Blok Montaj**  
Yüksekliği  
(Piston - Block  
Assembly Height)

0,035 / 0,105 mm  
0,105 / 0,175 mm  
0,175 / 0,245 mm





HYUNDAI - Ø 75

87-71185-STD



**Motor Özellikleri**  
(Engine Specifications)

İmalatçı (Manufacturer):  
HYUNDAI  
Çap (Diameter): Ø 75  
FM Grup No: 3641

**D4FC**

4 Sil. Dizel 1396cc  
55 kW / 75 PS 17  
İ20-İ30, Rio - Ceed  
2015....

**D4FC**

4 Sil. Dizel 1396cc  
55 kW / 75 PS 17  
İ20-İ30, Rio - Ceed  
2015...

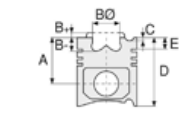

**Piston Ölçüleri**  
(Piston Dimensions)

A : 44.700  
B - : 12.000  
BØ : 44.800  
C1 : 0.500  
D : 68.500  
E : 9.200

Pim: 28 x 62



**Piston Özellikleri**  
(Piston Features)

Segman Taşıyıcı  
(Ring Carrier)  
Soğutma Kanallı  
(Coolin Gallery)  
Yağ Püskürtme Oyuğu  
(Oil Jet Cut-out)  
Gözarası Konik  
(Conical Eye Gap)

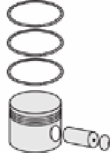

**Piston Parça No**  
(Piston Part No)

87-849600-22  
87-71185-STD  
  
87-849607-22  
87-71185 0,50



**Segman Seti**  
(Ring Set)

06-849600-00 STD  
06-849607-00 0,50 mm  
  
1.750 NT ST  
1.750 CR KV1  
3.000 NT ST

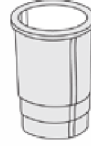

**Silindir Gömleği**  
(Liner)

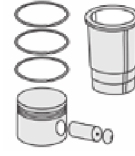

**Silindir Kit**  
(Assembly Set)

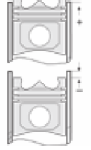

**Piston - Blok Montaj**  
Yüksekliği  
(Piston - Block  
Assembly Height)





HYUNDAI - Ø 75,5

86-71131-STD



**Motor Özellikleri**  
(Engine Specifications)

İmalatçı (Manufacturer):  
HYUNDAI  
Çap (Diameter): Ø 75,5  
FM Grup No: 3609

4 Sil. Benzinli 1500cc  
ACCENT 1,5 MİLENYUM  
2000...

**Piston Ölçüleri**  
(Piston Dimensions)

A : 31.070  
B : 0.950  
C1 : 3.000  
D : 54.400  
E : 5.060

Pim : 18 x 47,5



**Piston Özellikleri**  
(Piston Features)

Biyel Koluna Sıkı Geçme  
(Close-Fit to Connecting Rod)

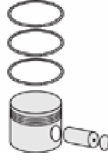

**Piston Parça No**  
(Piston Part No)

86-71131-STD  
86-71131-STD  
86-71131-STD  
86-71131-STD



**Segman Seti**  
(Ring Set)

1.200  
1.500  
3.000



**Silindir Gömleği**  
(Liner)

14-021800-00-D  
B : 78.500  
L : 132.000  
D : 79.500  
C : 5.000

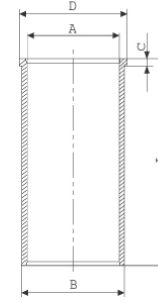

14-021801-00-D  
B : 79.000  
L : 132.000  
D : 80.000  
C : 5.500

Dış Çap 0,50 mm farklı  
(Outside Diameter  
0,50 mm different)

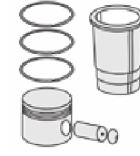

**Silindir Kit**  
(Assembly Set)

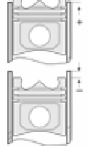

**Piston - Blok Montaj**  
Yüksekliği  
(Piston - Block  
Assembly Height)





HYUNDAI - Ø 75,5

87-71124 STD

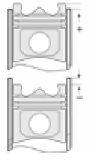
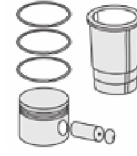
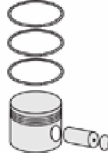
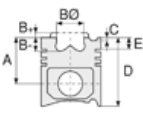

**Motor Özellikleri**  
(Engine Specifications)

İmalatçı (Manufacturer):  
HYUNDAI  
Çap (Diameter): Ø 75,5  
FM Grup No: 3617

**G4EE**

4 Sil. Benzinli 1399cc  
97 PS 10:1  
1.4 DOCH  
Accent Era 1.4 16v  
2005...

**Piston Ölçüleri**  
(Piston Dimensions)

A : 28.750  
B : 2.200  
C1 : 2.950  
D : 47.900  
E : 4.900

Pim : 47,9 x 18



**Piston Özellikleri**  
(Piston Features)

Biyel Koluna Sıkı Geçme  
(Close-Fit to Connecting Rod)  
Gözarası Konik  
(Conical Eye Gap)

**Piston Parça No**  
(Piston Part No)

87-849200-02  
87-71124-STD  
87-849207-02  
87-71124-050

**Segman Seti**  
(Ring Set)

06-849200-50-STD  
06-849207-50-0,50 mm  
1.200 CR ST  
1.200 P F14  
2.000 ST

**Silindir Gömleği**  
(Liner)

14-022130-00-D  
B : 78.500  
L : 132.000  
D : 80.500  
C : 5.000

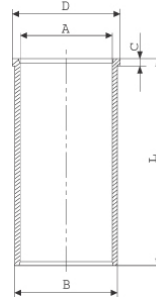

**Silindir Kit**  
(Assembly Set)

**Piston - Blok Montaj**  
Yüksekliği  
(Piston - Block  
Assembly Height)





HYUNDAI - Ø 75,5

87-71130-STD



**Motor Özellikleri**  
(Engine Specifications)

İmalatçı (Manufacturer):  
HYUNDAI  
Çap (Diameter): Ø 75,5  
FM Grup No: 3608

**G4EK**

4 Sil. Benzinli 1495cc  
ACCENT 1,5  
1990 - 2000

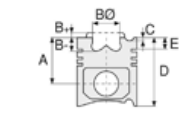

**Piston Ölçüleri**  
(Piston Dimensions)

A : 31.370  
B : 0.700  
BØ : 64.300  
C1 : 2.200  
D : 54.400  
E : 7.000

Pim : 18 x 47,5



**Piston Özellikleri**  
(Piston Features)

Biyel Koluna Sıkı Geçme  
(Close-Fit to Connecting Rod)  
Gözarası Düz  
(Flat Eye Gap)

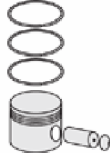

**Piston Parça No**  
(Piston Part No)

87-848700-02  
87-71130-STD  
87-848707-02  
87-71130-050



**Segman Seti**  
(Ring Set)

06-848700-50 STD  
06-848707-50-0,50 mm  
1.500 CRP KVI  
1.500 P STD  
3.000 CR ST



**Silindir Gömleği**  
(Liner)

14-021800-00-D  
B : 78.500  
L : 132.000  
D : 79.500  
C : 5.000

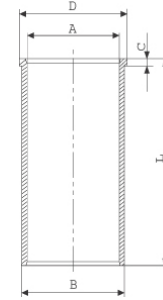

14-021801-00-D  
B : 79.000  
L : 132.000  
D : 80.000  
C : 5.500

Dış Çap 0,50 mm farklı  
(Outside Diameter  
0,50 mm different)

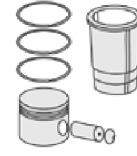

**Silindir Kit**  
(Assembly Set)

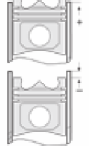

**Piston - Blok Montaj**  
Yüksekliği  
(Piston - Block  
Assembly Height)





HYUNDAI - Ø 75,5

87-71132-STD



**Motor Özellikleri**  
(Engine Specifications)

İmalatçı (Manufacturer):  
HYUNDAI  
Çap (Diameter): Ø 75,5  
FM Grup No: 3602

**G15B**

4 Sil. Benzinli 1468cc 56  
Kw (76 PS) 8, 5:1  
EXCEL 1.5  
1990 - 1994

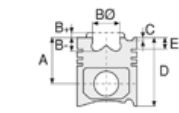

**Piston Ölçüleri**  
(Piston Dimensions)

A : 29.400  
B- : 3.700  
D : 58.800  
E : 6.900

Pim : 18 x 60



**Piston Özellikleri**  
(Piston Features)

Biyel Koluna Sıkı Geçme  
(Close-Fit to Connecting Rod)  
Gözarası Düz  
(Flat Eye Gap)

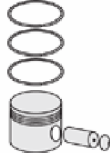

**Piston Parça No**  
(Piston Part No)

87-286700-02  
87-71132-STD  
87-286707-02  
87-71132-050



**Segman Seti**  
(Ring Set)

06-286700-00-STD  
06-286707-00-0,50 mm  
1.500 CRP IKA  
1.500 P STD  
4.000 P STD



**Silindir Gömleği**  
(Liner)

14-021800-00-D  
B : 78.500  
L : 132.000  
D : 79.500  
C : 5.000

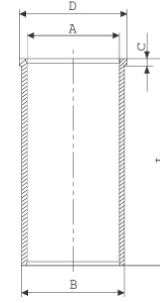

14-021801-00-D  
B : 79.000  
L : 132.000  
D : 80.000  
C : 5.500

Dış Çap 0,50 mm farklı  
(Outside Diameter  
0,50 mm different)

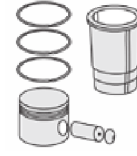

**Silindir Kit**  
(Assembly Set)

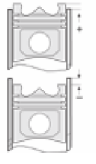

**Piston - Blok Montaj**  
Yüksekliği  
(Piston - Block  
Assembly Height)





HYUNDAI - Ø 76,5

87-71133-STD



**Motor Özellikleri**  
(Engine Specifications)

İmalatçı (Manufacturer):  
HYUNDAI  
Çap (Diameter): Ø 76,5  
FM Grup No: 3610

G4ED  
4 Sil. Benzinli 1588cc  
16 Valve  
ACCENT 1,6i 16 v,  
GETZ 1.6 DOHC  
2004...

**Piston Ölçüleri**  
(Piston Dimensions)

A : 28.140  
B- : 0.400  
BØ : 60.400  
C1 : 3.000  
D : 50.140  
E : 4.800

Pim : 18 x 47,5



**Piston Özellikleri**  
(Piston Features)

Biyel Koluna Sıkı Geçme  
(Close-Fit to Connecting Rod)  
Gözarası Konik  
(Conical Eye Gap)

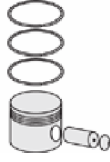

**Piston Parça No**  
(Piston Part No)

87-848300-02  
87-71133-STD  
87-848307-02  
87-71133-050



**Segman Seti**  
(Ring Set)

06-848300-50-STD  
06-848307-50-0,50 mm  
1.200 CR ST  
1.200 P GOE  
2.000 CR ST



**Silindir Gömleği**  
(Liner)

14-021760-00-D  
B : 79.500  
L : 132.000  
D : 81.000  
C : 5.000

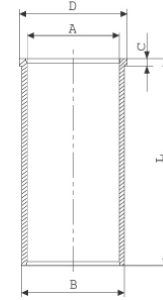

14-021761-00-D  
B : 80.000  
L : 132.000  
D : 81.500  
C : 5.500

Dış Çap 0,50 mm farklı  
(Outside Diameter  
0,50 mm different)

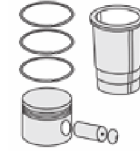

**Silindir Kit**  
(Assembly Set)

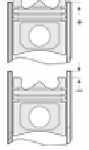

**Piston - Blok Montaj**  
Yüksekliği  
(Piston - Block  
Assembly Height)







HYUNDAI - Ø 77

87-71112-STD



**Motor Özellikleri**  
(Engine Specifications)

İmalatçı (Manufacturer):  
HYUNDAI  
Çap (Diameter): Ø 77  
FM Grup No: 3623

**G4FD**

4 Sil. Benzinli 1591cc 103  
kw-140 PS 1.6 16V ( GDI )  
ACCENT , ELANTRA, İ 30,  
İ20, İX 35  
2010...

**Piston Ölçüleri**  
(Piston Dimensions)

A : 26.900  
B : 2.900  
C1 : 2.940  
C2 : 2.700  
D : 47.900  
E : 5.300

Pim : 18 x 52,3



**Piston Özellikleri**  
(Piston Features)

Sert Anotlama  
(Hard Anodizing)  
Biyel Koluna Sıkı Geçme  
(Close-Fit to Connecting Rod)  
Gözarası Konik  
(Conical Eye Gap)

**Piston Parça No**  
(Piston Part No)

87-849400-02  
87-71112-STD  
87-849407-02  
87-71112-0,50

**Segman Seti**  
(Ring Set)

06-849400-00-STD  
06-849407-00-0,50 mm  
1.200 PVD ST  
1.200 P GOE  
2.000 NT ST

**Silindir Gömleği**  
(Liner)

**Silindir Kit**  
(Assembly Set)

**Piston - Blok Montaj**  
Yüksekliği  
(Piston - Block  
Assembly Height)

0,035 / 0,105 mm  
0,105 / 0,175 mm  
0,175 / 0,245 mm





HYUNDAI - Ø 77

87-71113-STD



**Motor Özellikleri**  
(Engine Specifications)

İmalatçı (Manufacturer):  
HYUNDAI  
Çap (Diameter): Ø 77  
FM Grup No: 3624

**G4FA**

4 Sil. Benzinli 1396cc 81  
Kw-109 PS 1.4L 16V  
ACCENT, İ 30, İ20  
2009...

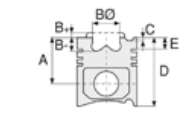

**Piston Ölçüleri**  
(Piston Dimensions)

A : 26.900  
B : 1.400  
C1 : 3.100  
D : 43.900  
E : 5.100

Pim : 18 x 52,3



**Piston Özellikleri**  
(Piston Features)

Biyel Koluna Sıkı Geçme  
(Close-Fit to Connecting Rod)  
Gözarası Konik  
(Conical Eye Gap)

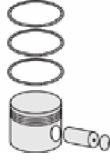

**Piston Parça No**  
(Piston Part No)

87-849700-02  
87-71113-STD  
87-849707-02  
87-71113-0,50



**Segman Seti**  
(Ring Set)

06-849700-50-STD  
06-849707-50-0,50 mm

1.200 PVD ST  
1.200 P GOE  
2.000 PVD ST



**Silindir Gömleği**  
(Liner)

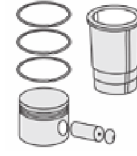

**Silindir Kit**  
(Assembly Set)

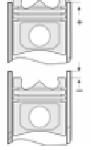

**Piston - Blok Montaj**  
Yüksekliği  
(Piston - Block  
Assembly Height)





HYUNDAI - Ø 77

87-71114-STD



**Motor Özellikleri**  
(Engine Specifications)

İmalatçı (Manufacturer):  
HYUNDAI  
Çap (Diameter): Ø 77  
FM Grup No: 3625

**G4FG**

4 Sil. Benzinli 1591cc 88  
kw-120 PS 1.6 16V  
ELANTRA, İ 30  
2011...

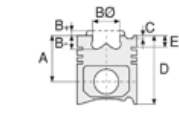

**Piston Ölçüleri**  
(Piston Dimensions)

A : 26.900  
B - : 0.850  
C1 : 2.000  
C2 : 3.000  
D : 43.900  
E : 5.100

Pim : 18 x 52,3



**Piston Özellikleri**  
(Piston Features)

Sert Anotlama  
(Hard Anodizing)  
Biyel Koluna Sıkı Geçme  
(Close-Fit to Connecting Rod)  
Gözarası Konik  
(Conical Eye Gap)

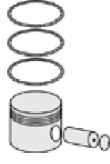

**Piston Parça No**  
(Piston Part No)

87-849700-22  
87-71114-STD  
  
87-849707-22  
87-71114-0,50



**Segman Seti**  
(Ring Set)

06-849700-50-STD  
06-849707-50-0,50 mm

1.200  PVD ST  
1.200  P GOE  
2.000  PVD ST



**Silindir Gömleği**  
(Liner)

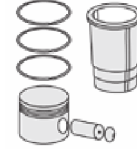

**Silindir Kit**  
(Assembly Set)

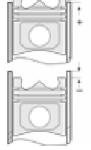

**Piston - Blok Montaj**  
Yüksekliği  
(Piston - Block  
Assembly Height)





HYUNDAI - Ø 77

87-71115-STD



**Motor Özellikleri**  
(Engine Specifications)

İmalatçı (Manufacturer):  
HYUNDAI  
Çap (Diameter): Ø 77  
FM Grup No: 3627

**G4FC**

4 Sil. Benzinli 1591cc 96  
KW-130PS 10,5  
İ 30 1.6 16V, İ20 1.6 16V  
2010...

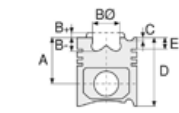

**Piston Ölçüleri**  
(Piston Dimensions)

A : 26.900  
B- : 0.950  
C1 : 2.800  
D : 43.900  
E : 5.100

Pim : 18 x 52,3



**Piston Özellikleri**  
(Piston Features)

Biyel Koluna Sıkı Geçme  
(Close-Fit to Connecting Rod)  
Gözarası Konik  
(Conical Eye Gap)

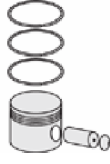

**Piston Parça No**  
(Piston Part No)

87-849700-42  
87-71115-STD  
  
87-849707-42  
87-71115-0,50



**Segman Seti**  
(Ring Set)

06-849700-50-STD  
06-849707-50-0,50 mm

1.200  PVD ST  
1.200  P GOE  
2.000  PVD ST



**Silindir Gömleği**  
(Liner)

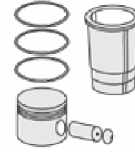

**Silindir Kit**  
(Assembly Set)

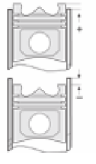

**Piston - Blok Montaj**  
Yüksekliği  
(Piston - Block  
Assembly Height)





HYUNDAI - Ø 77

87-71116-STD

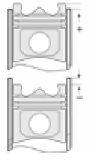
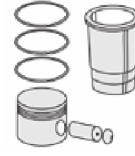
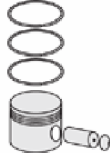
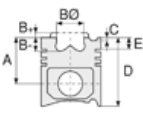

**Motor Özellikleri**  
(Engine Specifications)

**Piston Ölçüleri**  
(Piston Dimensions)

**Piston Parça No**  
(Piston Part No)

**Segman Seti**  
(Ring Set)

**Silindir Gömleği**  
(Liner)

**Silindir Kit**  
(Assembly Set)

**Piston - Blok Montaj**  
Yüksekliği  
(Piston - Block  
Assembly Height)

İmalatçı (Manufacturer):  
HYUNDAI  
Çap (Diameter): Ø 77  
FM Grup No: 3638

A : 28.000  
B- : 3.000  
BØ : 69.200  
C1 : 2.000  
C2 : 2.800  
D : 45.000  
E : 5.250

87-850800-02  
87-71116-STD  
  
87-850807-02  
87-71116-0,50

06-850800-00-STD  
06-850807-00-0,50

1.200 PVD ST  
1.500 P IKA  
2.000 NT ST

**G4FJ**  
4 Sil. Benzinli 1591cc  
130kW-177 PS  
İ 30, Kona, Tuscon  
2015 - 2019

Pim : 20 x 52



**Piston Özellikleri**  
(Piston Features)

Gözarası Konik  
(Conical Eye Gap)





HYUNDAI - Ø 77

87-71173-STD



**Motor Özellikleri**  
(Engine Specifications)

İmalatçı (Manufacturer):  
HYUNDAI  
Çap (Diameter): Ø 77  
FM Grup No: 3639

**G4FJ**

4 Sil. Benzinli 1591cc 137  
KW- 186 PS CEED, İ 30,  
İ30 Coupe , Kona,  
SPORTAGE, TUCSON,  
VELOSTER  
2015...

**Piston Ölçüleri**  
(Piston Dimensions)

A : 28.000  
B- : 3.000  
BØ : 40.000  
C1 : 2.000  
C2 : 2.800  
D : 45.000  
E : 5.350

Pim : 20 x 52



**Piston Özellikleri**  
(Piston Features)

Segman Taşıyıcı  
(Ring Carrier)  
Gözarası Konik  
(Conical Eye Gap)

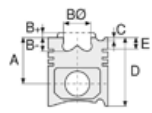

**Piston Parça No**  
(Piston Part No)

87-850800-22  
87-71173-STD  
  
87-850807-22  
87-71173-0,50

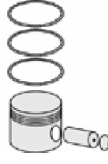

**Segman Seti**  
(Ring Set)

06-850800-00-STD  
06-850807-00-0,50

1.200 PVD ST  
1.500 P İKA  
2.000 NT ST



**Silindir Gömleği**  
(Liner)



**Silindir Kit**  
(Assembly Set)

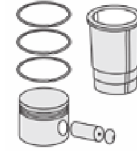

**Piston - Blok Montaj**  
Yüksekliği  
(Piston - Block  
Assembly Height)

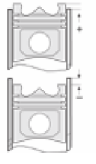



HYUNDAI - Ø 77

87-71174-STD

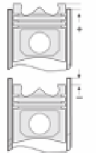
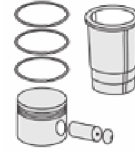
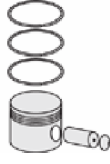
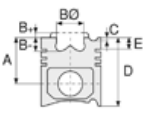

**Motor Özellikleri**  
(Engine Specifications)

İmalatçı (Manufacturer):  
HYUNDAI  
Çap (Diameter): Ø 77  
FM Grup No: 3640

**D4FE**  
4 Sil. Dizel 1598cc 70-10  
KW/95-136PS CEED, İ 30,  
SPORTAGE  
2018...

**Piston Ölçüleri**  
(Piston Dimensions)

A : 39.500  
B- : 12.300  
BØ : 49.200  
C1 : 1.750  
C2 : 1.100  
D : 61.500  
E : 8.000

Pim : 25 x 55,3

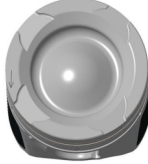

**Piston Özellikleri**  
(Piston Features)

Segman Taşıyıcı  
(Ring Carrier)  
Soğutma Kanallı  
(Cooling Gallery)  
Yağ Püskürtme Oyuğu  
(Oil Jet Cut-Out)  
Gözarası Konik  
(Conical Eye Gap)

**Piston Parça No**  
(Piston Part No)

87-846300-02  
87-71174-STD  
  
87-846307-02  
87-71174-0,50

**Segman Seti**  
(Ring Set)

06-846300-00-STD  
06-846307-00-0,50

1.500 PVD ST  
1.500 P IKA  
2.000 NT ST

**Silindir Gömleği**  
(Liner)

**Silindir Kit**  
(Assembly Set)

**Piston - Blok Montaj**  
Yüksekliği  
(Piston - Block  
Assembly Height)





KIA-HYUNDAI - Ø 77,2

87-71117-STD



**Motor Özellikleri**  
(Engine Specifications)

İmalatçı (Manufacturer):  
KIA-HYUNDAI  
Çap (Diameter): Ø 77,2  
FM Grup No: 3618

**D4FB**

4 Sil. Dizel 1582cc  
115 PS 17:3 CERATO, İ 30  
2007...

**D4FB**

4 Sil. Dizel 1582cc  
115 PS 17:3 CERATO, İ 30  
2007...

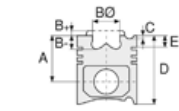

**Piston Ölçüleri**  
(Piston Dimensions)

A : 41.950  
B - : 12.700  
BØ : 44.000  
C1 : 0.500  
D : 65.700  
E : 9.200

Pim : 28 x 62



**Piston Özellikleri**  
(Piston Features)

Segman Taşıyıcı  
(Ring Carrier)  
Soğutma Kanallı  
(Cooling Gallery)  
Yağ Püskürtme Oyuğu  
(Oil Jet Cut-Out)

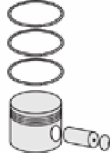

**Piston Parça No**  
(Piston Part No)

87-850500-02  
87-71117-STD  
87-850507-02  
87-71117-0,50



**Segman Seti**  
(Ring Set)

06-850500-00-STD  
06-850507-00-0,50

1.750 PVD ST  
1.750 CR KVI  
3.000 NT ST



**Silindir Gömleği**  
(Liner)

14-022250-00-D  
B : 80.200  
L : 140.000  
D : 81.700  
C : 5.000

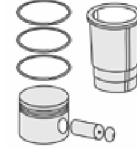

**Silindir Kit**  
(Assembly Set)

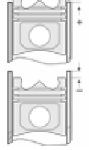

**Piston - Blok Montaj**  
Yüksekliği  
(Piston - Block  
Assembly Height)

1 Çentik Conta İle  
(With Notch Gasket)  
0,04 / 0,10

2 Çentik Conta İle  
(With Notch Gasket)  
0,11 / 0,18

3 Çentik Conta İle  
(With Notch Gasket)  
0,19 / 0,25







HYUNDAI - Ø 77,2

87-71118-STD



**Motor Özellikleri**  
(Engine Specifications)

İmalatçı (Manufacturer):  
HYUNDAI  
Çap (Diameter): Ø 77,2  
FM Grup No: 3635

**D4FB**

4 Sil. Dizel 1582cc 100  
KW-136 PS 1.6 CRDi i 30  
2015...

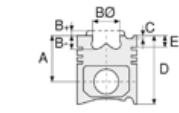

**Piston Ölçüleri**  
(Piston Dimensions)

A : 42.000  
B - : 12.600  
BØ : 47.150  
C1 : 0.500  
D : 65.700  
E : 9.200

Pim : 28 x 64

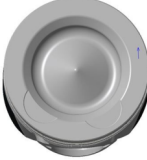
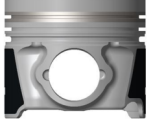

**Piston Özellikleri**  
(Piston Features)

Segman Taşıyıcı  
(Ring Carrier)  
Soğutma Kanallı  
(Cooling Gallery)  
Yağ Püskürtme Oyuğu  
(Oil Jet Cut-Out)  
Gözarası Düz  
(Flat Eye Gap)



**Piston Parça No**  
(Piston Part No)

87-850500-22  
87-71118-STD  
87-850507-22  
87-71118-0,50



**Segman Seti**  
(Ring Set)

06-850500-00-STD  
06-850507-00-0,50

1.750  PVD ST  
1.750  CR KV1  
3.000  NT ST



**Silindir Gömleği**  
(Liner)

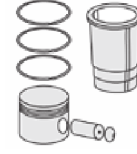

**Silindir Kit**  
(Assembly Set)

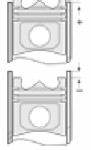

**Piston - Blok Montaj**  
Yüksekliği  
(Piston - Block  
Assembly Height)





**Motor Özellikleri**  
(Engine Specifications)

İmalatçı (Manufacturer):  
KIA-HYUNDAI  
Çap (Diameter): Ø 83  
FM Grup No: 3611

**D3EA**

3 Sil. Dizel 1493cc 60  
KW(82 PS) 17.7:1  
Kia İle Ortak Motor  
(With Kia Common  
Engine)  
ACCENT 1.5 CRDI,  
GETZ 1.5 CRDI  
2002...

**D4EA**

4 Sil. Dizel 1991cc 82  
Kw ( 112 Ps ) 17, 7:1  
Kia İle Ortak Motor  
(With Kia Common  
Engine)  
Santa Fe 2,0 CRDI,  
Tucson 2,0 CRDI  
2001 - 2008

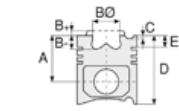

**Piston Ölçüleri**  
(Piston Dimensions)

A : 46.300  
B - : 13.900  
BØ : 46.950  
D : 71.300  
E : 9.000

Pim : 28 x 65,5

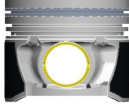

**Piston Özellikleri**  
(Piston Features)

Segman Taşıyıcı  
(Ring Carrier)  
Yağ Püskürtme Oyuğu  
(Oil Jet Cut-Out)  
Burçlu Piston  
(Bushing Piston)  
Gözarası Konik  
(Conical Eye Gap)

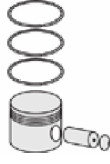

**Piston Parça No**  
(Piston Part No)

87-848207-03  
87-71137-0501  
0,20 mm Kısa (Short)

87-848200-02  
87-71137-STD

87-848207-02  
87-71137-050

87-848200-03  
87-71137-STD1  
0,20 mm Kısa (Short)



**Segman Seti**  
(Ring Set)

06-848200-00-STD  
06-848207-00-0,50 mm

2.000 CKP ST  
2.000 CRP GOE  
3.000 NT ST



**Silindir Gömleği**  
(Liner)

14-020580-00-D  
B : 87.000  
L : 155.000  
D : 88.250  
C : 5.000

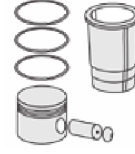
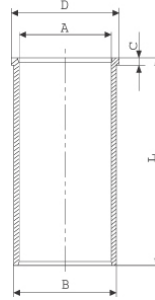

**Silindir Kit**  
(Assembly Set)

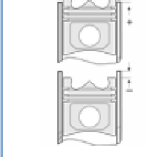

**Piston - Blok Montaj**  
Yüksekliği  
(Piston - Block  
Assembly Height)

+0,30 / +0,39





HYUNDAI - Ø 83

87-71170-STD



**Motor Özellikleri**  
(Engine Specifications)

İmalatçı (Manufacturer):  
HYUNDAI  
Çap (Diameter): Ø 83  
FM Grup No: 3630

**D4EA**

4 Sil. Dizel 1991cc 92  
KW-125 PS 17. 7;1  
SANTE FE 2.0 CRDI 16V,  
TUSCON 2.0 CRDI 16V  
2001...

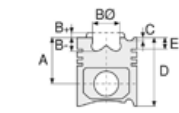

**Piston Ölçüleri**  
(Piston Dimensions)

A : 46.300  
B- : 13.700  
BØ : 48.500  
D : 72.300  
E : 9.100

Pim : 28 x 65,5

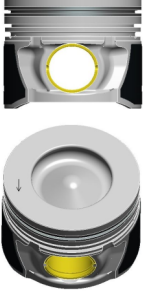

**Piston Özellikleri**  
(Piston Features)

Segman Taşıyıcı  
(Ring Carrier)  
Soğutma Kanallı  
(Cooling Gallery)  
Yağ Püskürtme Oyuğu  
(Oil Jet Cut-Out)  
Burçlu Piston  
(Bushing Piston)  
Gözarası Konik  
(Conical Eye Gap)

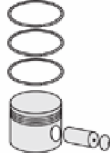

**Piston Parça No**  
(Piston Part No)

87-850000-02  
87-71170-STD  
87-850007-02  
87-71170-0,50



**Segman Seti**  
(Ring Set)

06-850000-00-STD  
06-850007-00-0,50 mm  
2.000 CKS ST  
2.000 CR GOE  
3.000 NT ST



**Silindir Gömleği**  
(Liner)

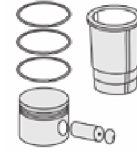

**Silindir Kit**  
(Assembly Set)

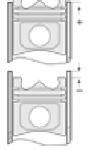

**Piston - Blok Montaj**  
Yüksekliği  
(Piston - Block  
Assembly Height)





HYUNDAI - Ø 83

87-71171-STD

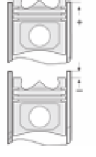
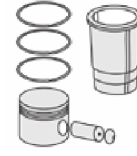
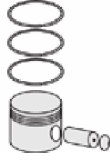
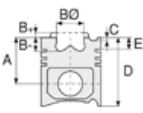

**Motor Özellikleri**  
(Engine Specifications)

İmalatçı (Manufacturer):  
HYUNDAI  
Çap (Diameter): Ø 83  
FM Grup No: 3637

**D4EA**  
4 Sil. Dizel 1991cc 83  
kw-113 PS Santa Fe, Sonota,  
Tuscon  
2008...

**Piston Ölçüleri**  
(Piston Dimensions)

A : 46.300  
B- : 16.950  
BØ : 42.700  
BX : 0.700  
D : 72.300  
E : 9.100

Pim : 28 x 65,5

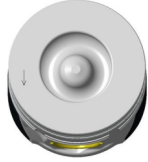
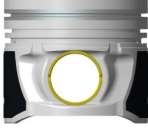

**Piston Özellikleri**  
(Piston Features)

Segman Taşıyıcı  
(Ring Carrier)  
Soğutma Kanallı  
(Cooling Gallery)  
Yağ Püskürtme Oyuğu  
(Oil Jet Cut-Out)  
Burçlu Piston  
(Bushing Piston)  
Gözarası Konik  
(Conical Eye Gap)

**Piston Parça No**  
(Piston Part No)

87-850000-22  
87-71171-STD  
87-850007-22  
87-71171-0,50

**Segman Seti**  
(Ring Set)

06-850000-00-STD  
06-850007-00-0,50 mm  
2.000 CKS ST  
2.000 CR GOE  
3.000 NT ST

**Silindir Gömleği**  
(Liner)

**Silindir Kit**  
(Assembly Set)

**Piston - Blok Montaj**  
Yüksekliği  
(Piston - Block  
Assembly Height)





**Motor Özellikleri**  
(Engine Specifications)

İmalatçı (Manufacturer):  
KIA-HYUNDAI  
Çap (Diameter): Ø 84  
FM Grup No: 3631

**D4HA**

4 Sil. Dizel 1995cc 100  
KW -136 PS 16,5  
İX 35, SANTE FE 2.0 ,  
SORENTO, SPORTAGE  
2009...

**D4HA**

4 Sil. Dizel 1995cc 100  
KW -136 PS 16,5  
İX 35, SANTE FE 2.0 ,  
SORENTO, SPORTAGE  
2009...

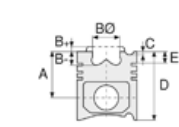

**Piston Ölçüleri**  
(Piston Dimensions)

A : 48.900  
B - : 15.700  
BØ : 45.400  
D : 75.900  
E : 8.000

Pim : 34 x 66



**Piston Özellikleri**  
(Piston Features)

Segman Taşıyıcı  
(Ring Carrier)  
Soğutma Kanallı  
(Cooling Gallery)  
Yağ Püskürtme Oyuğu  
(Oil Jet Cut-Out)  
Gözarası Konik  
(Conical Eye Gap)



**Piston Parça No**  
(Piston Part No)

87-849900-02  
87-71119-STD  
87-849907-00  
87-71119-0,50



**Segman Seti**  
(Ring Set)

06-849900-00-STD  
06-849907-00-0,50 mm  
2.500 CKS ST  
2.000 P F14  
3.000 NT ST



**Silindir Gömleği**  
(Liner)

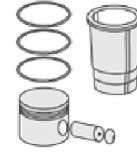

**Silindir Kit**  
(Assembly Set)

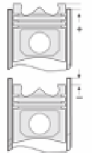

**Piston - Blok Montaj**  
Yüksekliği  
(Piston - Block  
Assembly Height)





KIA-HYUNDAI - Ø 91

87-71120-STD



**Motor Özellikleri**  
(Engine Specifications)

İmalatçı (Manufacturer):  
KIA-HYUNDAI  
Çap (Diameter): Ø 91  
FM Grup No: 3622

**D4BC**  
4 Sil. Dizel 2497cc  
125 Kw-170 BG  
STAREX 2,5 CRDI

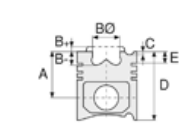

**Piston Ölçüleri**  
(Piston Dimensions)

A : 54.250  
B- : 15.000  
BØ : 52.000  
C1 : 0.340  
D : 83.700  
E : 9.200

Pim : 33 x 74



**Piston Özellikleri**  
(Piston Features)

Segman Taşıyıcı  
(Ring Carrier)  
Soğutma Kanallı  
(Cooling Gallery)  
Yağ Püskürtme Oyuğu  
(Oil Jet Cut-Out)  
Burçlu Piston  
(Bushing Piston)  
Gözarası Konik  
(Conical Eye Gap)

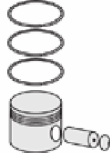

**Piston Parça No**  
(Piston Part No)

87-848500-22  
87-71120-STD  
  
87-848507-22  
87-71120-0,50



**Segman Seti**  
(Ring Set)

06-848500-00-STD  
06-848507-00-0,50 mm  
  
2.500 CKP KV4  
2.000 CRP GOE  
3.000 NT ST



**Silindir Gömleği**  
(Liner)

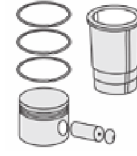

**Silindir Kit**  
(Assembly Set)

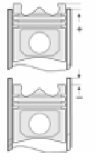

**Piston - Blok Montaj**  
**Yüksekliği**  
(Piston - Block  
Assembly Height)

0,92 / 0,98 mm Conta İle  
(With Gasket)  
+0,056 / +0,117  
  
0,98 / 1,03 mm Conta İle  
(With Gasket)  
+0,117 / +0,178  
  
1,03 / 1,08 mm Conta İle  
(With Gasket)  
+0,178 / +0,240





HYUNDAI - Ø 91

87-71178-STD

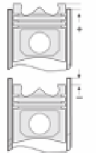
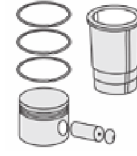
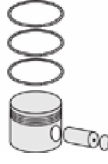
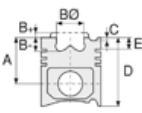

**Motor Özellikleri**  
(Engine Specifications)

İmalatçı (Manufacturer):  
HYUNDAI  
Çap (Diameter): Ø 91  
FM Grup No: 3636

**D4CB**

4 Sil. Dizel 2499cc 81-100  
Kw / 110-163 PS  
H 1, H 100 Euro 5 CRDi,  
K 2500, SORENTO  
2004...

**D4CB**

4 Sil. Dizel 2499cc 81-100  
Kw / 110-163 PS  
H 1, H 100 Euro 5 CRDi,  
K 2500, SORENTO  
2004...

**Piston Ölçüleri**  
(Piston Dimensions)

A : 54.200  
B - : 14.700  
BØ : 52.600  
C1 : 0.250  
D : 83.700  
E : 9.180

Pim : 33 x 74



**Piston Özellikleri**  
(Piston Features)

Segman Taşıyıcı  
(Ring Carrier)  
Soğutma Kanallı  
(Cooling Gallery)  
Yağ Püskürtme Oyuğu  
(Oil Jet Cut-Out)  
Gözarası Konik  
(Conical Eye Gap)

**Piston Parça No**  
(Piston Part No)

87-850700-02  
87-71178-STD  
87-850707-02  
87-71178-0,50

**Segman Seti**  
(Ring Set)

06-850700-00-STD  
06-850707-00-0,50  
2.500 CKS ST  
2.000 CR GOE  
3.000 NT ST

**Silindir Gömleği**  
(Liner)

**Silindir Kit**  
(Assembly Set)

**Piston - Blok Montaj**  
Yüksekliği  
(Piston - Block  
Assembly Height)





**Motor Özellikleri**  
(Engine Specifications)

İmalatçı (Manufacturer):  
HYUNDAI-KIA  
Çap (Diameter): Ø 91  
FM Grup No: 4610

**2,5 CRDI**

4 Sil. Dizel 2497cc 103  
Kw(140 PS)  
Hyundai İle Ortak Motor  
(With Hyundai Common  
Engine)  
SORENTO  
2002...

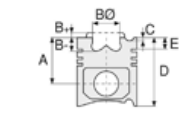

**Piston Ölçüleri**  
(Piston Dimensions)

A : 54.250  
B- : 15.000  
BØ : 52.000  
C1 : 0.300  
D : 83.750  
E : 9.000

Pim : 33 x 75



**Piston Özellikleri**  
(Piston Features)

Segman Taşıyıcı  
(Ring Carrier)  
Soğutma Kanallı  
(Cooling Gallery)  
Yağ Püskürtme Oyuğu  
(Oil Jet Cut-Out)  
Gözarası Konik  
(Conical Eye Gap)

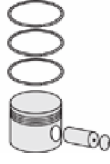

**Piston Parça No**  
(Piston Part No)

87-848507-03  
87-73200-0501  
0,20 mm Kısa (Short)  
  
87-848500-02  
87-73200-STD  
  
87-848507-02  
87-73200-050  
  
87-848500-03  
87-73200-STD1  
0,20 mm Kısa (Short)



**Segman Seti**  
(Ring Set)

06-848500-00-STD  
06-848507-00-0,50 mm  
  
2.500 CKP KV4  
2.000 CRP GOE  
3.000 NT ST



**Silindir Gömleği**  
(Liner)

14-011150-00-D  
B : 94.200  
L : 170.000

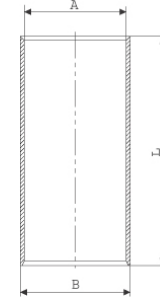

14-011151-00-D  
B : 94.700  
L : 170.000

Dış Çap 0,50 mm Farklı  
(Outside Diameter  
0,50 mm Different)

14-022430-00-D  
B : 94.200  
L : 170.000  
D : 95.500  
C : 5.000

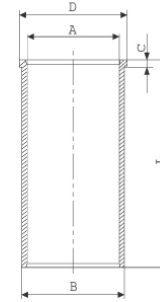

14-022431-00-D  
B : 94.700  
L : 170.000  
D : 96.000  
C : 5.500

Dış Çap 0,50 mm Farklı  
(Outside Diameter  
0,50 mm Different)

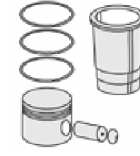

**Silindir Kit**  
(Assembly Set)

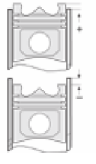

**Piston - Blok Montaj**  
**Yüksekliği**  
(Piston - Block  
Assembly Height)

+0,06 /+0,24







HYUNDAI - Ø 91,1

87-71134-STD

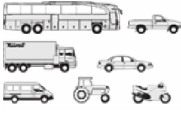

**Motor Özellikleri**  
(Engine Specifications)

İmalatçı (Manufacturer):  
HYUNDAI  
Çap (Diameter): Ø 91,1  
FM Grup No: 3605

**D4BF**  
4 Sil. Dizel 2500cc  
STAREX 2.5 TC  
1998...

**Piston Ölçüleri**  
(Piston Dimensions)

A : 48.700  
B- : 3.100  
C1 : 2.300  
C2 : 2.600  
D : 88.700  
E : 15.000

Pim : 29 x 75



**Piston Özellikleri**  
(Piston Features)

Segman Taşıyıcı  
(Ring Carrier)  
Çelik Plaka  
(Steel Strut)  
Gözarası Konik  
(Conical Eye Gap)



**Piston Parça No**  
(Piston Part No)

87-862600-02  
87-71134-STD  
87-862607-02  
87-71134-050



**Segman Seti**  
(Ring Set)

06-862600-00-STD  
06-862607-00-0,50 mm  
2.554 CRP KV1  
2.054 CRP KV1  
4.000 CRP GOE



**Silindir Gömleği**  
(Liner)

14-015590-00-D  
B : 94.130  
L : 164.500

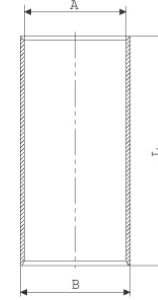

14-015591-00-D  
B : 94.630  
L : 164.500

Dış Çap 0,50 mm Farklı  
(Outside Diameter  
0,50 mm Different)

14-028400-00-D  
B : 94.130  
L : 164.750  
D : 96.000  
C : 5.000

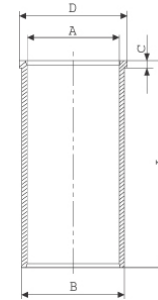

14-028401-00-D  
B : 94.630  
L : 164.750  
D : 96.500  
C : 5.000

Dış Çap 0,50 mm Farklı  
(Outside Diameter  
0,50 mm Different)

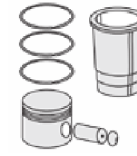

**Silindir Kit**  
(Assembly Set)

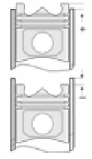

**Piston - Blok Montaj**  
**Yüksekliği**  
(Piston - Block  
Assembly Height)

1.45 mm Conta İle  
(With Gasket)  
+0,562 /+0,620

1.50 mm Conta İle  
(With Gasket)  
+0,620 /+0,680

1.55 mm Conta İle  
(With Gasket)  
+0,680 /+0,775





HYUNDAI - Ø 91,1

87-71134-STD



**Motor Özellikleri**  
(Engine Specifications)



**Piston Ölçüleri**  
(Piston Dimensions)

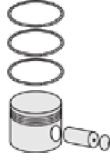

**Piston Parça No**  
(Piston Part No)



**Segman Seti**  
(Ring Set)



**Silindir Gömleği**  
(Liner)

14-028402-00-D  
B : 95.130  
L : 164.750  
D : 97.000  
C : 6.000

Dış Çap 1,00 mm Farklı  
(Outer Diameter  
1.00 mm Different)

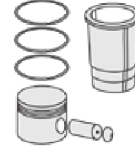

**Silindir Kit**  
(Assembly Set)

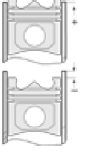

**Piston - Blok Montaj**  
**Yüksekliği**  
(Piston - Block  
Assembly Height)





HYUNDAI - Ø 91,1

87-71175-STD



**Motor Özellikleri**  
(Engine Specifications)

İmalatçı (Manufacturer):  
HYUNDAI  
Çap (Diameter): Ø 91,1  
FM Grup No: 3632

**D4BB**

4 Sil. Dizel 2477cc 57-59  
Kw/78-80 Ps 21:1  
H 100 2.5 TD, H1 2.5 TD  
1994...

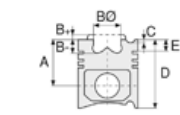

**Piston Ölçüleri**  
(Piston Dimensions)

A : 48.700  
B- : 3.200  
C1 : 1.900  
C2 : 2.500  
D : 88.700  
E : 16.500

Pim : 29 x 75

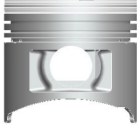

**Piston Özellikleri**  
(Piston Features)

Çelik Plaka  
(Steel Strut)  
Gözarası Konik  
(Conical Eye Gap)

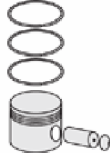

**Piston Parça No**  
(Piston Part No)

87-850100-02  
87-71175-STD  
87-850107-02  
87-71175-0,50



**Segman Seti**  
(Ring Set)

06-850100-00-STD  
06-850107-00-0,50 mm

3.000 CRP KV1  
2.000 P F14  
3.000 CRP GOE

Yağ Segmanı Matkap Delik  
(Oil Ring Drill Hole)



**Silindir Gömleği**  
(Liner)

14-015590-00-D  
B : 94.130  
L : 164.500

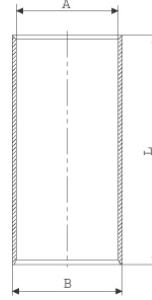

14-015591-00-D  
B : 94.630  
L : 164.500

Dış Çap 0,50 mm Farklı  
(Outside Diameter  
0,50 mm Different)

14-028400-00-D  
B : 94.130  
L : 164.750  
D : 96.000  
C : 5.000

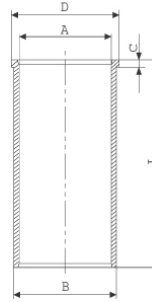

14-028401-00-D  
B : 94.630  
L : 164.750  
D : 96.500  
C : 5.000

Dış Çap 0,50 mm Farklı  
(Outside Diameter  
0,50 mm Different)

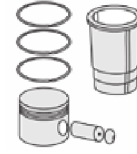

**Silindir Kit**  
(Assembly Set)

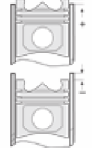

**Piston - Blok Montaj**  
**Yüksekliği**  
(Piston - Block  
Assembly Height)

1.45mm Conta (Gasket)  
+0,562/+0,620

1,50 mm Conta (Gasket)  
+0,620/+0,680

1,55mm Conta (Gasket)  
+0,680/+0,774





HYUNDAI - Ø 91,1

87-71175-STD



**Motor Özellikleri**  
(Engine Specifications)

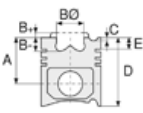

**Piston Ölçüleri**  
(Piston Dimensions)

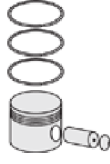

**Piston Parça No**  
(Piston Part No)



**Segman Seti**  
(Ring Set)



**Silindir Gömleği**  
(Liner)

14-028402-00-D  
B : 95.130  
L : 164.750  
D : 97.000  
C : 6.000

Dış Çap 1,00 mm Farklı  
(Outer Diameter  
1.00 mm Different)

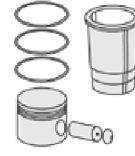

**Silindir Kit**  
(Assembly Set)

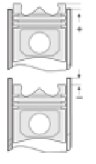

**Piston - Blok Montaj**  
**Yüksekliği**  
(Piston - Block  
Assembly Height)





HYUNDAI - Ø 91,1

87-71180-STD



**Motor Özellikleri**  
(Engine Specifications)

İmalatçı (Manufacturer):  
HYUNDAI  
Çap (Diameter): Ø 91,1  
FM Grup No: 3604

4 Sil. Dizel 2600cc  
H 100 KAMYONET (Van)  
TEK VE ÇİFT KAB  
(Single And Double Cup)  
1996...

**Piston Ölçüleri**  
(Piston Dimensions)

A : 46.250  
B- : 3.070  
C1 : 2.000  
C2 : 2.300  
D : 76.150  
E : 13.400

Pim : 29 x 75



**Piston Özellikleri**  
(Piston Features)

Segman Taşıyıcı  
(Ring Carrier)  
Gözarası Konik  
(Conical Eye Gap)

**Piston Parça No**  
(Piston Part No)

87-850107-23  
87-71180-0501  
0,20 mm Kısa (Short)

87-850100-22  
87-71180-STD

87-850107-22  
87-71180-050

87-850100-23  
87-71180-STD1  
0,20 mm Kısa (Short)

**Segman Seti**  
(Ring Set)

06-850100-00-STD  
06-850107-00-0,50 mm

3.000 CRP KV1  
2.000 P F14  
3.000 CRP GOE

Yağ Segmanı Matkap Delik  
(Oil Ring Drill Hole)

**Silindir Gömleği**  
(Liner)

14-015590-00-D  
B : 94.130  
L : 164.500

14-015591-00-D  
B : 94.630  
L : 164.500

Dış Çap 0,50mm Farklı  
(Outside Diameter  
0.50mm Different)

14-028400-00-D  
B : 94.130  
L : 164.750  
D : 96.000  
C : 5.000

14-028401-00-D  
B : 94.630  
L : 164.750  
D : 96.500  
C : 5.000

Dış Çap 0,50mm Farklı  
(Outside Diameter  
0.50mm Different)

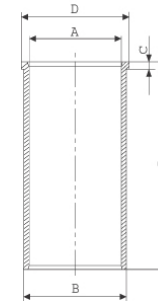
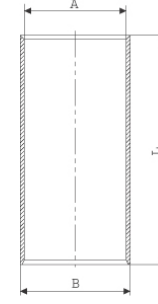

**Silindir Kit**  
(Assembly Set)

1,45 mm Conta İle  
(With Gasket)  
+0,562/+0,620

1,50 mm Conta İle  
(With Gasket)  
+0,620/+0,680

1,55 mm Conta İle  
(With Gasket)  
+0,680/+0,774

**Piston - Blok Montaj**  
**Yüksekliği**  
(Piston - Block  
Assembly Height)

1,45 mm Conta İle  
(With Gasket)  
+0,562/+0,620

1,50 mm Conta İle  
(With Gasket)  
+0,620/+0,680

1,55 mm Conta İle  
(With Gasket)  
+0,680/+0,774





**Motor Özellikleri**  
(Engine Specifications)

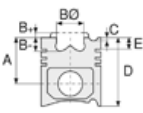

**Piston Ölçüleri**  
(Piston Dimensions)

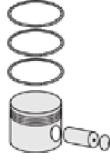

**Piston Parça No**  
(Piston Part No)



**Segman Seti**  
(Ring Set)



**Silindir Gömleği**  
(Liner)

14-028402-00-D  
B : 95.130  
L : 164.750  
D : 97.000  
C : 6.000

Dış Çap 1,00mm Farklı  
(Outside Diameter  
1,00mm Different)

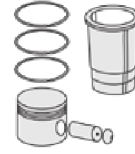

**Silindir Kit**  
(Assembly Set)

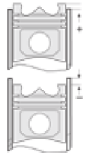

**Piston - Blok Montaj**  
Yüksekliği  
(Piston - Block  
Assembly Height)





HYUNDAI - Ø 91,1

87-71337-STD



**Motor Özellikleri**  
(Engine Specifications)

İmalatçı (Manufacturer):  
HYUNDAI  
Çap (Diameter): Ø 91,1  
FM Grup No: 3612

**D4BH**

4 Sil. Dizel 2500cc  
Turbo intercool / Kia İle  
Ortak Motor  
(With Kia Common  
Engine)  
STAREX 2.5 TCI  
2000 - 2002

**Piston Ölçüleri**  
(Piston Dimensions)

A : 48.700  
B- : 1.300  
D : 88.700  
E : 14.900

Pim : 29 x 75



**Piston Özellikleri**  
(Piston Features)

Segman Taşıyıcı  
(Ring Carrier)  
Çelik Plaka  
(Steel Strut)  
Soğutma Kanallı  
(Cooling Gallery)  
Yağ Püskürtme Oyuğu  
(Oil Jet Cut-Out)  
Gözarası Konik  
(Conical Eye Gap)

**Piston Parça No**  
(Piston Part No)

87-862607-23  
87-71337-0501  
0,20 mm Kısa (Short)

87-862600-22  
87-71337-STD  
1. & 3. Silindir (Cylinder)

87-862607-22  
87-71337-050

87-862600-23  
87-71337-STD1  
1 & 3 Silindir (Cylinder) -  
0,20 mm Kısa (Short)

87-862607-43  
87-71339-0501  
0,20 mm Kısa (Short)

87-862600-42  
87-71339-STD  
2. & 4. Silindir (Cylinder)

87-862607-42  
87-71339-050

87-862600-43  
87-71339-STD1  
2 & 4 Silindir (Cylinder) -  
0,20 mm Kısa (Short)

**Segman Seti**  
(Ring Set)

06-862600-00-STD  
06-862607-00-0,50 mm

2.554 CRP KV1  
2.054 CRP KV1  
4.000 CRP GOE



**Silindir Gömleği**  
(Liner)

14-010370-00-D  
B : 94.175  
L : 167.000

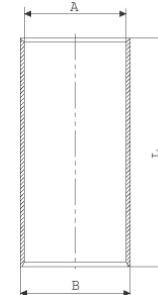

14-028400-00-D  
B : 94.130  
L : 164.750  
D : 96.000  
C : 5.000

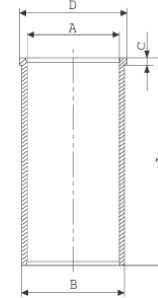

14-028401-00-D  
B : 94.630  
L : 164.750  
D : 96.500  
C : 5.000

Dış Çap 0,50 mm Farklı  
(Outside Diameter  
0,50 mm Different)

14-028402-00-D  
B : 95.130  
L : 164.750  
D : 97.000  
C : 6.000

Dış Çap 1,00 mm Farklı  
(Outer Diameter  
1.00 mm Different)

**Silindir Kit**  
(Assembly Set)

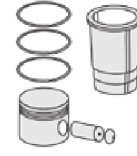

**Piston - Blok Montaj**  
Yüksekliği  
(Piston - Block  
Assembly Height)

+ 0,50

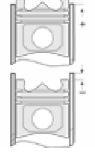



HYUNDAI - Ø 100

87-71138-STD A



**Motor Özellikleri**  
(Engine Specifications)

İmalatçı (Manufacturer):  
HYUNDAI  
Çap (Diameter): Ø 100  
FM Grup No: 3606

**D4AE**

4 Sil. Dizel 3298cc  
H350 TD, HD77 TD  
1995...

**Piston Ölçüleri**  
(Piston Dimensions)

A : 60.650  
B- : 17.400  
BØ : 54.700  
BX : 6.700  
BY : 1.350  
D : 110.650  
E : 15.500

Pim : 34 x 84

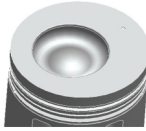

**Piston Özellikleri**  
(Piston Features)

Segman Taşıyıcı  
(Ring Carrier)  
Gözarası Konik  
(Conical Eye Gap)



**Piston Parça No**  
(Piston Part No)

87-848100-12  
87-71138-STD A  
  
87-848107-12  
87-71138-050A



**Segman Seti**  
(Ring Set)

06-848100-20-STD  
06-848107-20-0,50 mm

3.000 CRP KV1  
2.000 CRP KV1  
4.000 CRP GOE

Goetze® LKZ-Ring®



**Silindir Gömleği**  
(Liner)

14-018730-00-D  
B : 104.063  
L : 192.000

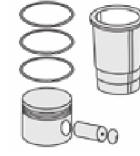
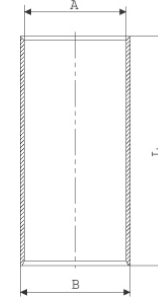

**Silindir Kit**  
(Assembly Set)

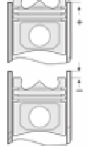

**Piston - Blok Montaj**  
Yüksekliği  
(Piston - Block  
Assembly Height)

+0,47/+0,69





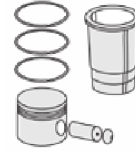

**Motor Özellikleri**  
(Engine Specifications)

İmalatçı (Manufacturer):  
HYUNDAI-MITSUBISHI  
Çap (Diameter): Ø 100  
FM Grup No: 6004

**4 D 31-OA**  
4 Sil. Dizel 3298cc 69  
Kw (94 PS) 17, 5:1  
Hyundai İle Ortak Motor  
(With Hyundai Common  
Engine)  
CANTER 3300 (FE 444)  
1982...

**Piston Ölçüleri**  
(Piston Dimensions)

A : 60.700  
B- : 18.100  
BØ : 52.500  
BX : 6.100  
BY : 1.750  
D : 110.700  
E : 15.700

Pim : 34 x 84

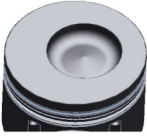

**Piston Özellikleri**  
(Piston Features)

Segman Taşıyıcı  
(Ring Carrier)  
Çelik Plaka  
(Steel Strut)  
Gözarası Konik  
(Conical Eye Gap)

**Piston Parça No**  
(Piston Part No)

87-288200-02  
87-71591-STD  
87-288207-02  
87-71591-050

**Segman Seti**  
(Ring Set)

06-288200-00-STD  
06-288207-00-0,50 mm  
3.000 CRP KVI  
2.000 P STD  
5.000 CRP STD

**Silindir Gömleği**  
(Liner)

14-015600-00-D  
B : 103.990  
L : 191.500

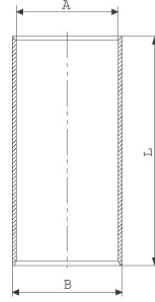

**Silindir Kit**  
(Assembly Set)

**Piston - Blok Montaj**  
Yüksekliği  
(Piston - Block  
Assembly Height)

+0,47 / +0,69





HYUNDAI - Ø 103

87-71121-STD

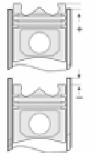
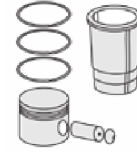
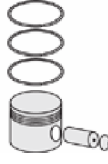
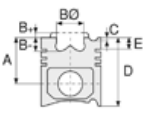

**Motor Özellikleri**  
(Engine Specifications)

İmalatçı (Manufacturer):  
HYUNDAI  
Çap (Diameter): Ø 103  
FM Grup No: 3634

**D4GA Euro 4**  
4 Sil. Dizel 140 PS-150 PS  
HD 35 EURO 4,  
HD 75 EURO 4  
2008...

**Piston Ölçüleri**  
(Piston Dimensions)

A : 65.200  
B- : 16.600  
BØ : 60.100  
C1 : 0.500  
C2 : 0.100  
D : 102.200  
E : 11.900

Pim : 44 x 80,9





**Piston Özellikleri**  
(Piston Features)

Segman Taşıyıcı  
(Ring Carrier)  
Soğutma Kanallı  
(Cooling Gallery)  
Yağ Püskürtme Oyuğu  
(Oil Jet Cut-Out)  
Gözarası Konik  
(Conical Eye Gap)

**Piston Parça No**  
(Piston Part No)

87-850600-02  
87-71121-STD  
87-850607-02  
87-71121-0,50

**Segman Seti**  
(Ring Set)

06-850600-00-STD  
06-850607-00-0,50  
3.000  CR ST  
2.000  CR KV1  
4.000  NT ST

**Silindir Gömleği**  
(Liner)

**Silindir Kit**  
(Assembly Set)

**Piston - Blok Montaj**  
Yüksekliği  
(Piston - Block  
Assembly Height)





HYUNDAI - Ø 104

87-71139-STD



**Motor Özellikleri**  
(Engine Specifications)

İmalatçı (Manufacturer):  
HYUNDAI  
Çap (Diameter): Ø 104  
FM Grup No: 3615

**D4AF**  
4 Sil. Dizel 3568cc  
HD35, HD72  
1999 - 2001

**Piston Ölçüleri**  
(Piston Dimensions)

A : 60.730  
B- : 19.000  
BØ : 50.700  
BX : 6.500  
BY : 1.500  
D : 110.730  
E : 15.100

Pim : 34 x 84

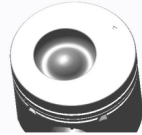

**Piston Özellikleri**  
(Piston Features)

Segman Taşıyıcı  
(Ring Carrier)  
Çelik Plaka  
(Steel Strut)  
Gözarası Konik  
(Conical Eye Gap)

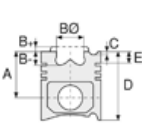

**Piston Parça No**  
(Piston Part No)

87-848800-02  
87-71139-STD  
87-848807-02  
87-71139-050

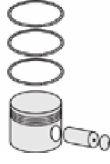

**Segman Seti**  
(Ring Set)

06-848800-00-STD  
06-848807-00-0,50 mm  
3.000 CRP KV1  
2.000 CRP GOE13  
4.000 ST NT



**Silindir Gömleği**  
(Liner)

14-021030-00-D  
B : 108.010  
L : 191.000  
D : 109.010  
C : 5.000

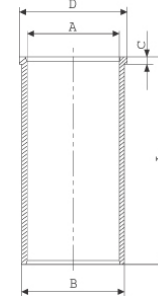

**Silindir Kit**  
(Assembly Set)

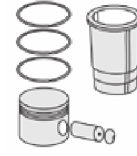

**Piston - Blok Montaj**  
Yüksekliği  
(Piston - Block  
Assembly Height)

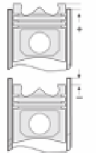



**Motor Özellikleri**  
(Engine Specifications)

İmalatçı (Manufacturer):  
HYUNDAI-MITSUBISHI  
Çap (Diameter): Ø 104  
FM Grup No: 6005

**4 D 34-1 ATA EUROII**  
4 Sil. Dizel 3908cc 136 PS  
659 CANTER, PRESTIJ TDI

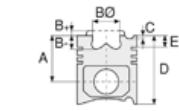

**Piston Ölçüleri**  
(Piston Dimensions)

A : 62.200  
B - : 23.000  
B0 : 49.000  
BX : 6.800  
BY : 1.800  
D : 112.200  
E : 10.600

Pim : 36 x 88



**Piston Özellikleri**  
(Piston Features)

Segman Taşıyıcı  
(Ring Carrier)  
Çelik Plaka  
(Steel Strut)  
Sert Anotlama  
(Hard Anodizing)  
Soğutma Kanallı  
(Cooling Gallery)  
Yağ Püskürtme Oyuğu  
(Oil Jet Cut-Out)  
Gözarası Konik  
(Conical Eye Gap)

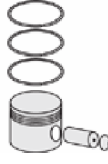

**Piston Parça No**  
(Piston Part No)

87-288300-02  
87-71592-STD  
  
87-288307-02  
87-71592-050



**Segman Seti**  
(Ring Set)

06-288300-00-STD  
06-288307-00-0,50 mm  
  
3.000 CRP KV1  
2.000 CRP IKA  
4.000 CRP STD



**Silindir Gömleği**  
(Liner)

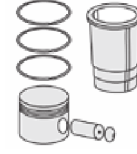

**Silindir Kit**  
(Assembly Set)

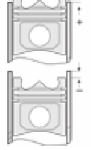

**Piston - Blok Montaj**  
Yüksekliği  
(Piston - Block  
Assembly Height)

+0,60 / +0,70

