



MAZDA-KIA - Ø 86

87-71338-STD



Motor Özellikleri
(Engine Specifications)

İmalatçı (Manufacturer):
MAZDA-KIA
Çap (Diameter): Ø 86
FM Grup No: 4601

R2

4 Sil. Dizel 2184cc 22, 9:1
Mazda İle Ortak Motor
(With Mazda Common
Engine)
BESTA YENİ TİP
(New type)
1993 - 1999

4 Sil. Dizel 2184cc 47 Kw
(64 Ps) 23:1
Kia ile ortak motor
(With Kia Common
Engine)
CREW CAP,
E 2200 VAN, PICK-UP
1983...

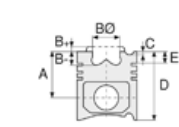

Piston Ölçüleri
(Piston Dimensions)

A : 47.350
B- : 1.600
D : 86.150
E : 13.750

Pim : 25 x 68



Piston Özellikleri
(Piston Features)

Segman Taşıyıcı
(Ring Carrier)
Çelik Plaka
(Steel Strut)
Soğutma Kanallı
(Cooling Gallery)
Gözarası Konik
(Conical Eye Gap)

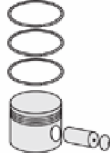

Piston Parça No
(Piston Part No)

87-253300-02
87-71338-STD
87-253307-02
87-71338-050



Segman Seti
(Ring Set)

06-253300-00-STD
06-253307-00-0,50 mm
2.000 CRP KV1
2.000 P STD
3.000 CRP STD



Silindir Gömleği
(Liner)

14-027100-00-D
B : 89.600
L : 165.000
D : 91.500
C : 5.000

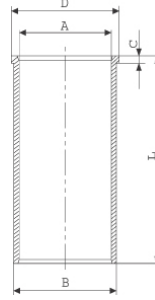

14-027101-00-D
B : 90.100
L : 165.000
D : 92.000
C : 5.000

Dış Çap 0,50mm Farklı
(Outside Diameter
0.50mm Different)

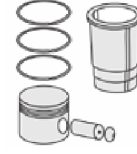

Silindir Kit
(Assembly Set)

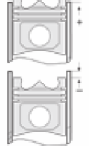

Piston - Blok Montaj
Yüksekliği
(Piston - Block
Assembly Height)

Çelik Conta
(Steel Gasket)
+ 0,35 / + 0,55

Klingirit Conta
(Klingirite Gasket)
+ 0,35 / + 0,65





MAZDA-KIA - Ø 86

87-71340-STD



Motor Özellikleri
(Engine Specifications)

İmalatçı (Manufacturer):
MAZDA-KIA
Çap (Diameter): Ø 86
FM Grup No: 4602

4 Sil. Dizel 2184cc 22, 9:1
Mazda ile Ortak Motor
(With Mazda Common
Engine)
BESTA ESKİ TİP
(New Type)
1997...

Piston Ölçüleri
(Piston Dimensions)

A : 47.350
B- : 1.600
D : 86.150
E : 13.750

Pim : 25 x 68



Piston Özellikleri
(Piston Features)

Segman Taşıyıcı
(Ring Carrier)
Çelik Plaka
(Steel Strut)
Gözarası Konik
(Conical Eye Gap)

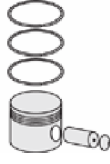

Piston Parça No
(Piston Part No)

87-283600-02
87-71340-STD
87-283607-02
87-71340-050



Segman Seti
(Ring Set)

06-283600-10-STD
06-283607-10-0,50 mm
2.000 CRP KV1
2.000 P STD
4.000 CRP STD



Silindir Gömleği
(Liner)

14-027100-00-D
B : 89.600
L : 165.000
D : 91.500
C : 5.000

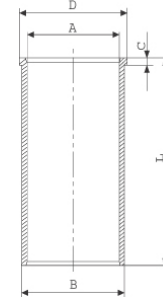

14-027101-00-D
B : 90.100
L : 165.000
D : 92.000
C : 5.000

Dış Çap 0,50mm Farklı
(Outside Diameter
0.50mm Different)

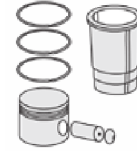

Silindir Kit
(Assembly Set)

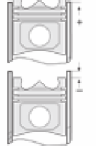

Piston - Blok Montaj
Yüksekliği
(Piston - Block
Assembly Height)

Çelik Conta
(Steel Gasket)
+ 0,35 / + 0,55
Klingirit Conta
(Klingirite Gasket)
+ 0,35 / + 0,65





MAZDA - Ø 86

87-72423-STD



Motor Özellikleri
(Engine Specifications)

İmalatçı (Manufacturer):
MAZDA
Çap (Diameter): Ø 86
FM Grup No: 5703

RF
4 Sil. Dizel 2184cc
CREW CAP, E 2200 VAN,
PICK-UP

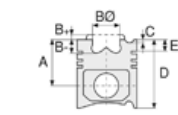

Piston Ölçüleri
(Piston Dimensions)

A : 43.310
B - : 1.500
D : 82.310
E : 9.700

Pim : 25 x 64



Piston Özellikleri
(Piston Features)

Segman Taşıyıcı
(Ring Carrier)
Çelik Plaka
(Steel Strut)
Soğutma Kanallı
(Cooling Gallery)
Yağ Püskürtme Oyuğu
(Oil Jet Cut-Out)
Gözarası Düz
(Flat Eye Gap)

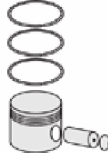

Piston Parça No
(Piston Part No)

87-253300-22
87-72423-STD

87-253307-22
87-72423-050



Segman Seti
(Ring Set)

06-253300-00-STD
06-253307-00-0,50 mm

2.000 CRP KV1
2.000 P STD
3.000 CRP STD



Silindir Gömleği
(Liner)

14-027100-00-D
B : 89.600
L : 165.000
D : 91.500
C : 5.000

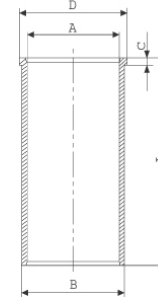

14-027101-00-D
B : 90.100
L : 165.000
D : 92.000
C : 5.000

Dış Çap 0,50mm Farklı
(Outside Diameter
0.50mm Different)

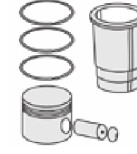

Silindir Kit
(Assembly Set)

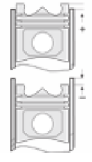

Piston - Blok Montaj
Yüksekliği
(Piston - Block
Assembly Height)

+0,55 / +0,65





MAZDA-FORD PKW - Ø 93

87-72762-STD

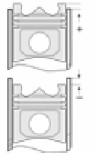
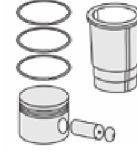
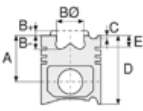

Motor Özellikleri
(Engine Specifications)

İmalatçı (Manufacturer):
MAZDA-FORD PKW
Çap (Diameter): Ø 93
FM Grup No: 3116

XM34 TD / WL-T
4 Sil. Dizel 2500cc 110 PS
Mazda ile Ortak Motor
(With Mazda Common
Engine)
RANGER PICKUP
THUNDER, RANGER
PICKUP XLT
1998...

Piston Ölçüleri
(Piston Dimensions)

A : 47.850
B- : 2.100
D : 87.350
E : 12.300

Pim : 32 x 70



Piston Özellikleri
(Piston Features)

Segman Taşıyıcı
(Ring Carrier)
Çelik Plaka
(Steel Strut)
Soğutma Kanallı
(Cooling Gallery)
Yağ Püskürtme Oyuğu
(Oil Jet Cut-Out)
Gözarası Konik
(Conical Eye Gap)

Piston Parça No
(Piston Part No)

87-848900-02
87-72762-STD
87-848907-02
87-72762-0,50

Segman Seti
(Ring Set)

06-848900-00-STD
06-848907-00-0.50 mm
2.500 NT ST
2.000 CRP GOE
3.000 NT ST

Silindir Gömleği
(Liner)

Silindir Kit
(Assembly Set)

Piston - Blok Montaj
Yüksekliği
(Piston - Block
Assembly Height)

+0,30 / +0,42





MAZDA-FORD PKW - Ø 93

87-72764-STD



Motor Özellikleri
(Engine Specifications)

İmalatçı (Manufacturer):
MAZDA-FORD PKW
Çap (Diameter): Ø 93
FM Grup No: 2978

6M34 / WL-C

4 Sil. Dizel 2499cc 143 PS
Mazda İle Ortak Motor
(With Mazda
Common Engine)
RANGER PICKUP TDCI
2006...

Piston Ölçüleri
(Piston Dimensions)

A : 51.750
B- : 15.100
BØ : 48.500
D : 81.300
E : 8.600

Pim : 34 x 70



Piston Özellikleri
(Piston Features)

Segman Taşıyıcı
(Ring Carrier)
Çelik Plaka
(Steel Strut)
Soğutma Kanallı
(Cooling Gallery)
Yağ Püskürtme Oyuğu
(Oil Jet Cut-Out)
Gözarası Konik
(Conical Eye Gap)

Piston Parça No
(Piston Part No)

87-838900-02
87-72764-STD
87-838907-02
87-72764-050



Segman Seti
(Ring Set)

06-838900-00-STD
06-838907-00-0,50 mm
2.000 PVD ST
1.500 CR ST
2.000 NT ST



Silindir Gömleği
(Liner)

14-022200-00-D
B : 96.000
L : 171.000
D : 97.500
C : 5.000

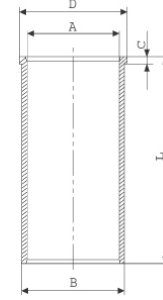

Silindir Kit
(Assembly Set)

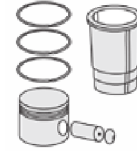

Piston - Blok Montaj
Yüksekliği
(Piston - Block
Assembly Height)

STD Conta İle
(With STD Gasket)
+0,08 / +0,15

1 Kertik Conta İle
(With Notch Gasket)
+0,13 / +0,25

2 Kertik Conta İle
(With Notch Gasket)
+0,20 / +0,31

