



VOITH - Ø 60

87-72523-STD



Motor Özellikleri
(Engine Specifications)

İmalatçı (Manufacturer):
VOITH
Çap (Diameter): Ø 60
FM Grup No: 8917

OM 457 / Voith-Nr:
LP 490

1 Sil. Dizel
Axor 1836LS, Axor
1840LS, Axor 2640CL,
Axor 3240C, Axor 3340K,
Axor 4140B, Capacity,
Conecto, Turismo
15RHD, Travego 15SHD

Piston Ölçüleri
(Piston Dimensions)

A : 25.000
D : 50.000
E : 4.000
Pim: 14 x 53



Piston Özellikleri
(Piston Features)

Gözarası Düz
(Flat Eye Gap)

Piston Parça No
(Piston Part No)

87-878300-02
87-72523-STD

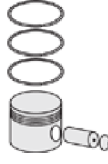

Segman Seti
(Ring Set)

06-878300-00-STD

2.000 P F14
2.000 P F14
3.000 P GOE



Silindir Gömleği
(Liner)

14-050030-00-WH

B : 65.400
L : 81.000
D : 88.000
C : 7.000

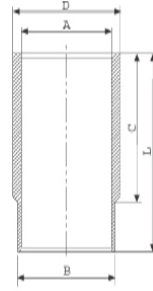

O-Ring Bilgi
(O-Ring Information)
24-35050-51/0
1X 67,00*3,00 FPM
1X 64,00*3,00 FPM

Silindir Kit
(Assembly Set)

89-878300-02-STD
89-72523-STD

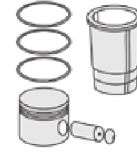

Piston - Blok Montaj
Yüksekliği
(Piston - Block
Assembly Height)

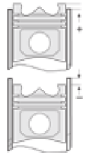



VOITH - Ø 92

87-72522-STD



Motor Özellikleri
(Engine Specifications)

İmalatçı (Manufacturer):
VOITH
Çap (Diameter): Ø 92
FM Grup No: 8918

OM 457 / Voith-Nr:
LP 490

1 Sil. Dizel
Axor 1836LS, Axor
1840LS, Axor 2640CL,
Axor 3240C, Axor 3340K,
Axor 4140B, Capacity,
Conecto, Turismo 15RHD,
Travego 15SHD

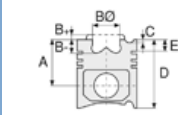

Piston Ölçüleri
(Piston Dimensions)

A : 31.050
D : 60.950
E : 4.000
Pim: 18 x 63



Piston Özellikleri
(Piston Features)

Gözarası Düz
(Flat Eye Gap)



Piston Parça No
(Piston Part No)

87-878200-02
87-72522-STD



Segman Seti
(Ring Set)

06-878200-00-STD

2.500 P F14
2.500 P F14
3.000 P GOE



Silindir Gömleği
(Liner)

14-050030-00-WH

B : 65.400
L : 81.000
D : 88.000
C : 7.000

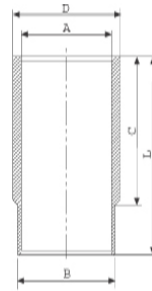

O-Ring Bilgi
(O-Ring Information)
50-350507-00
1X 98,00*3,00 FPM

14-050040-00-DH
O-Ring Bilgi
(O-Ring Information)
50-350507-00
1X 98,00*3,00 FPM

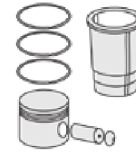

Silindir Kit
(Assembly Set)

89-878200-02-STD
89-72522-STD

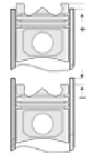

Piston - Blok Montaj
Yüksekliği
(Piston - Block
Assembly Height)

