



**Motor Özellikleri**  
(Engine Specifications)

İmalatçı (Manufacturer):  
Saab-Scania  
Çap (Diameter): 127  
FM Grup No: 7514

**DSC 11.21/23/35/36/  
71/75**

6 Sil. Dizel 11018cc  
235/266 Kw (320/362 PS)  
17:1  
Turbocharged Intercooled  
M113, P113, R113, T113  
1991 - 1994

**Piston Ölçüleri**  
(Piston Dimensions)

A : 98.760  
B- : 16.520  
BØ : 89.450  
C1 : 2.960  
D : 156.260  
E : 14.000

Pim: 50 x 107,8



**Piston Özellikleri**  
(Piston Features)

Segman Taşıyıcı  
(Ring Carrier)  
Yağ Püskürtme Oyuğu  
(Oil Jet Cut-out)  
Gözarası Konik  
(Conical Eye Gap)



**Piston Parça No**  
(Piston Part No)

87-962000-72  
87-71909-STDC



**Segman Seti**  
(Ring Set)

06-962000-20-STD  
3.500 CR KV1  
2.385 STD  
4.747 CR STD  
Goetze® LKZ-Ring®



**Silindir Gömleği**  
(Liner)

14-450040-00-WH  
B : 140.000  
L : 291.000  
D : 154.000  
C : 7.940  
F : 0.900  
R : 12.400

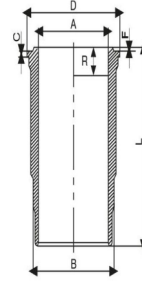

O-RING BİLGİ (O-Ring  
Information)  
24-35025-43/0  
3x 139,5\*4 FPM

14-450110-00-WH  
B : 140.000  
L : 291.000  
D : 153.750  
C : 7.930  
F : 0.900  
R : 13.200

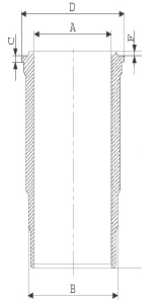

O-RİNG BİLGİ (O-Ring  
Information)  
24-35025-42/0  
2x 139,5\*4 FPM  
1x 138\*143\*11 FPM

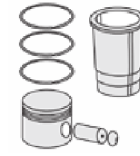

**Silindir Kit**  
(Assembly Set)

89-962000-72-STD  
89-71909-STDC

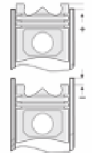

**Piston - Blok Montaj**  
Yüksekliği  
(Piston - Block  
Assembly Height)





**Motor Özellikleri**  
(Engine Specifications)

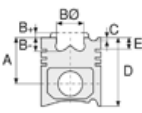

**Piston Ölçüleri**  
(Piston Dimensions)

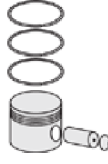



**Piston Parça No**  
(Piston Part No)

87-892500-62  
87-71909-STD



**Segman Seti**  
(Ring Set)

06-892500-00-STD  
3.500  CK KV1  
2.385  CR STD  
4.747  CR STD

Goetze® LKZ-Ring®



**Silindir Gömleği**  
(Liner)

14-450040-00-WH  
O-RING BİLGİ (O-Ring  
Information)  
24-35025-43/0  
3x 139,5\*4 FPM

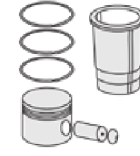

**Silindir Kit**  
(Assembly Set)

89-892500-62-STD  
89-71909-STD

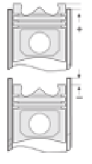

**Piston - Blok Montaj**  
Yüksekliği  
(Piston - Block  
Assembly Height)

14-451450-00-WH  
B : 139.500  
L : 291.000  
D : 153.800  
C : 7.900  
F : 0.800  
R : 11.500

89-892500-12-STD  
89-71909-STDK

14-450110-00-WH  
O-RİNG BİLGİ (O-Ring  
Information)  
24-35025-42/0  
2x 139,5\*4 FPM  
1x 138\*143\*11 FPM

89-892500-52-STD  
89-71909-STDH

14-451450-00-WH





**Motor Özellikleri**  
(Engine Specifications)

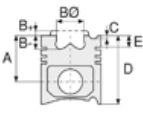

**Piston Ölçüleri**  
(Piston Dimensions)

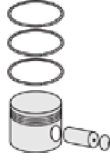

**Piston Parça No**  
(Piston Part No)



**Segman Seti**  
(Ring Set)



**Silindir Gömleği**  
(Liner)

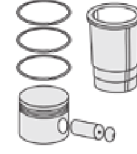

**Silindir Kit**  
(Assembly Set)

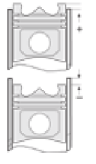

**Piston - Blok Montaj**  
**Yüksekliği**  
(Piston - Block  
Assembly Height)

**ANA YATAK**  
(MAIN BEARING)

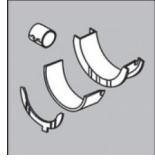

H1059/7 STD

**KOL YATAK**  
(ARM BED)

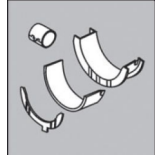

71-4237/6 STD

**EKSANTRİK YATAK**  
(ECCENTRIC BEARING)

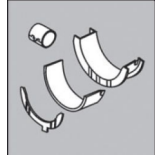

N197/4 SEMI

**AY YATAK**  
(THRUST WASHER)

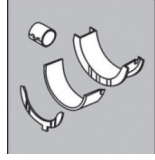

A216/4 STD

**KOL BURCU**  
(SMALL END BUSH)

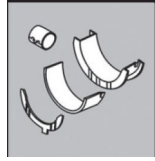

55-4240 SEMI

**SİL. KAPAK. CONTA**  
(CYLINDER HEAD GASKET)



DS560

DS561

