



VOLVO - Ø 130,18

87-72238-STD



Motor Özellikleri
(Engine Specifications)

İmalatçı (Manufacturer):
VOLVO
Çap (Diameter): Ø 130,18
FM Grup No: 8909

TD122
6 Sil. Dizel 12000cc
262Kw(356Ps) 15:1
TURBO
F12, FS12
1987....

TD122FA
6 Sil. Dizel 11977cc
262Kw(356Ps) 15:1
TURBO İNTERCOOLED
F12, FS12
1987....

TD122FS
6 Sil. Dizel 11977cc
290Kw(395Ps) 15:1
TURBO İNTERCOOLED
F12, FS10, FS12
1987....

TD122FR
6 Sil. Dizel 11977cc
290Kw(395Ps) 15:1
TURBO İNTERCOOLED
F12, FS10, FS12
1987....

TD122FK
6 Sil. Dizel 11977cc
290Kw(395Ps) 15:1
TURBO İNTERCOOLED
F12, FS10, FS12
1987....

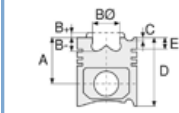

Piston Ölçüleri
(Piston Dimensions)

A : 114.200
B- : 25.400
BØ : 79.000
BX : 4.000
C1 : 2.500
D : 175.200
E : 35.000

Pim: 55 x 114



Piston Özellikleri
(Piston Features)

Segman Taşıyıcı
(Ring Carrier)
Gözarası Düz
(Flat Eye Gap)

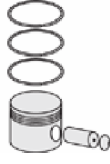

Piston Parça No
(Piston Part No)

87-405600-54
87-72238-STD



Segman Seti
(Ring Set)

06-405600-10-STD

2.385 CRP KV1
3.160 CRP STD
4.747 CRP STD



Silindir Gömleği
(Liner)

14-458840-00-WH

B : 143.880
L : 313.250
D : 157.620
C : 10.546
F : 3.200
R : 70.750

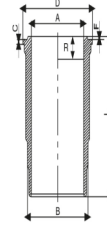

O-Ring Bilgi
(O-Ring Information)
24-24468-02/O
1x 142,8*5,8 FPM LILA
2x 142,8*5,8 EPDM
1x 141*2,4 FPM

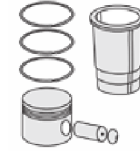

Silindir Kit
(Assembly Set)

89-405600-54-STD
89-72238-STD

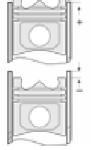

Piston - Blok Montaj
Yüksekliği
(Piston - Block
Assembly Height)

- 0,50 / + 0,45





VOLVO - Ø 130,18

87-72238-STD



Motor Özellikleri
(Engine Specifications)



Piston Ölçüleri
(Piston Dimensions)



Piston Parça No
(Piston Part No)



Segman Seti
(Ring Set)



Silindir Gömleği
(Liner)

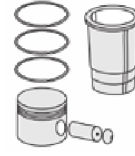

Silindir Kit
(Assembly Set)



Piston - Blok Montaj
Yüksekliği
(Piston - Block
Assembly Height)

ANA YATAK
(MAIN BEARING)

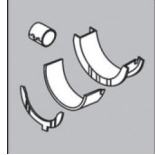

H1053/7 STD

KOL YATAK
(ARM BED)

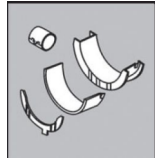

71-3613/6 STD

71-4236/6 STD

AY YATAK
(THRUST WASHER)

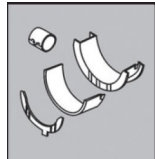

A131/4 STD

KOL BURCU
(SMALL END BUSH)

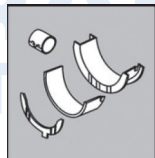

55-3925 SEMI

